

COW SKELETON

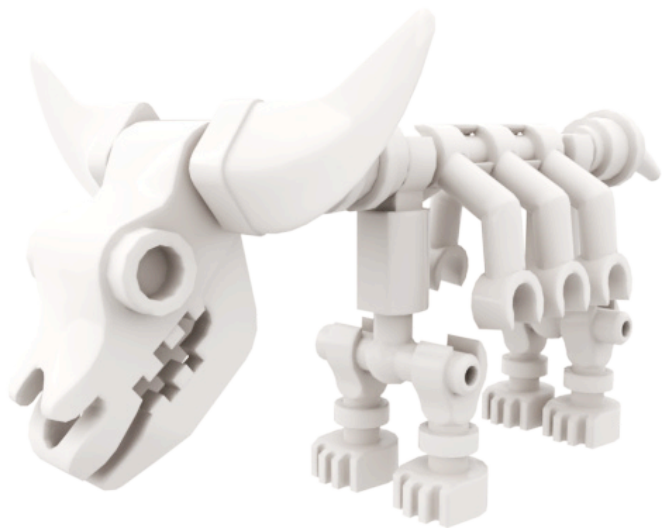

COW SKELETON

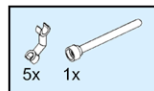

1

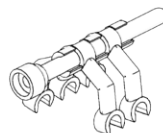

2

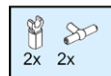
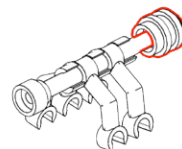

3

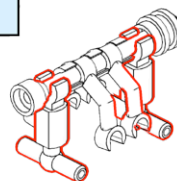

4

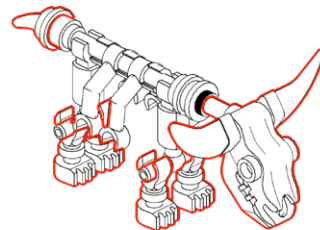
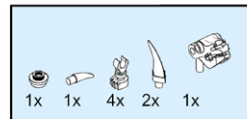



3x
85861, 1



2x
11090, 1



1x
53451, 1



2x
87747, 1



1x
13695, 1



4x
6266, 1



2x
4697b, 1



5x
93061, 1

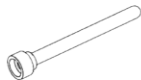

1x
3957, 1

FISHMAN



FISHMAN



1



2

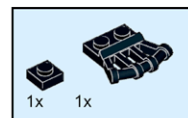

3

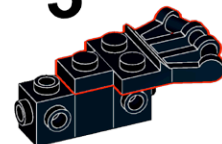
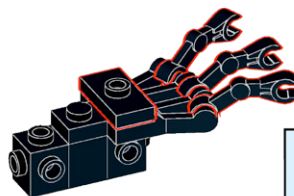
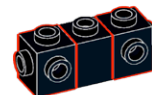

4

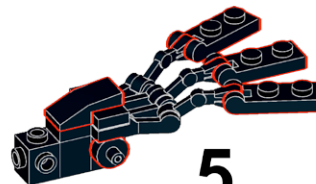
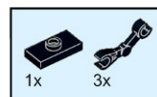

5

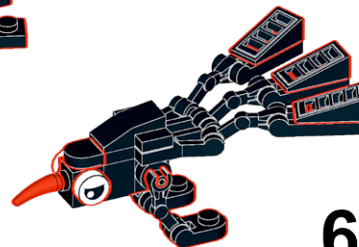

6





1x
24246, 11



1x
3024, 11



2x
20482, 11



1x
6541, 11



2x
4733, 11



1x
11477, 11



3x
61409, 11



1x
92692, 11



2x
98138pb027, 1



1x
53451, 5



2x
26047, 11



1x
3794b, 11



5x
30377, 11



3x
60478, 11

HAMMERHEAD SHARK



HAMMER- HEAD SHARK

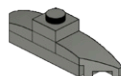
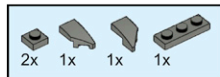

1

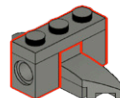
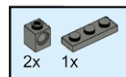

2

3

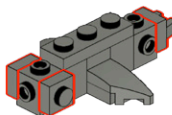
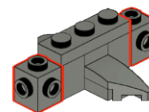

4

5

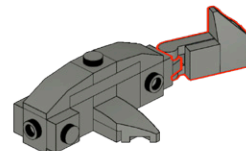
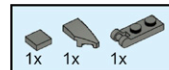
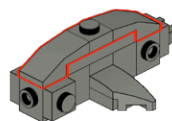
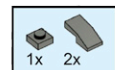

6

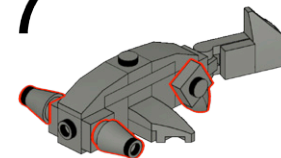

7

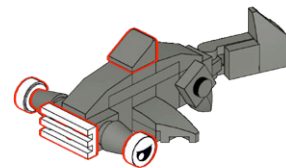

8

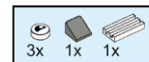



5x
3024, 85



1x
29120, 85

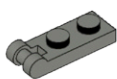

1x
60478, 85



2x
6541, 85



2x
4733, 85



1x
2555, 85



2x
29119, 85



1x
3070b, 85



2x
3623, 85



2x
4589, 85



2x
11477, 85



2x
49668, 85



1x
54200, 85



3x
98138pb027, 1



1x
2412b, 1

TURTLE

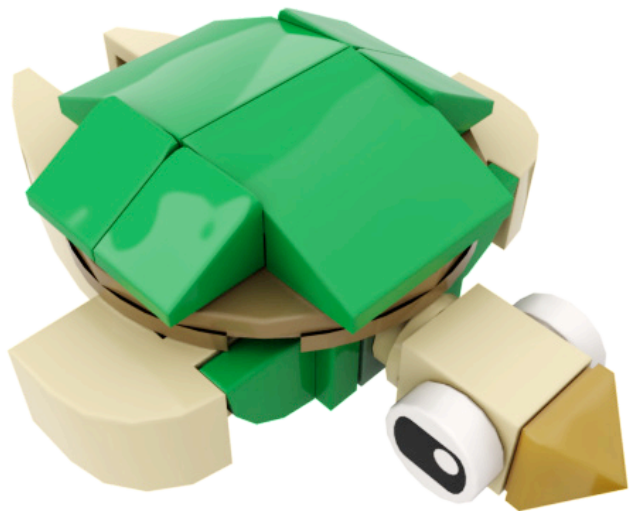
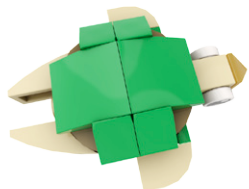

TURTLE

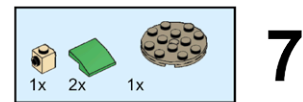
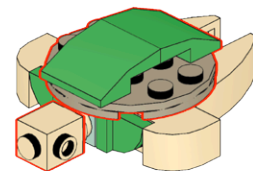
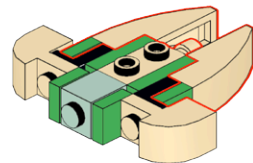
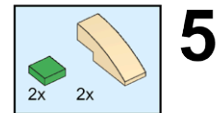
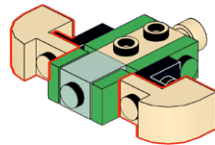
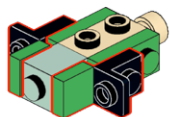
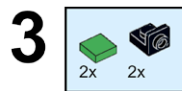
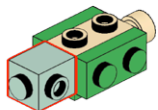
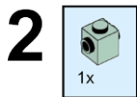
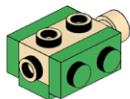
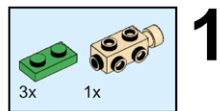

7

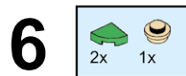

6

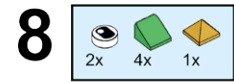
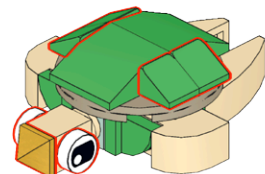
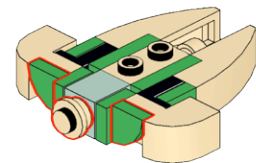

8



2x
36840, 11



2x
98138pb066, 1



1x
4073, 2



1x
47905, 2



2x
25269, 36



2x
6091, 2



2x
50950, 2



1x
4595, 2



4x
3070b, 36



4x
54200, 36



3x
3023, 36



2x
15068, 36



1x
47905, 48



1x
22388, 115



1x
60474, 69

SPIDER

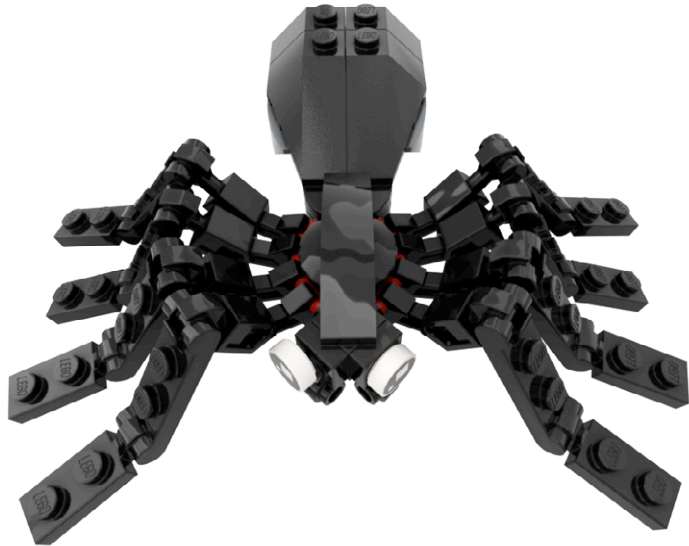

SPIDER



1



2

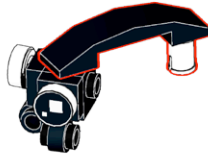

3

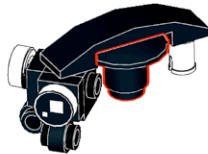

4

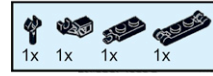
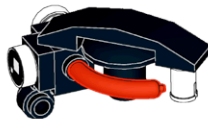

5

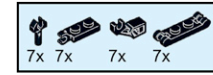
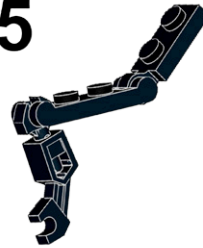

6

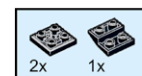
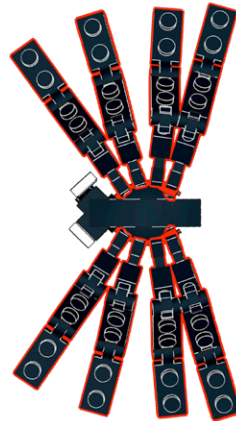

7

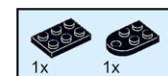

8

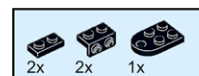

9

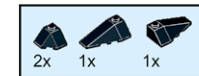
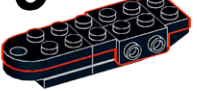

10

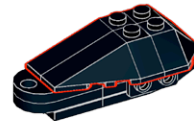

11

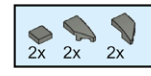
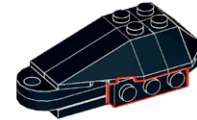

12

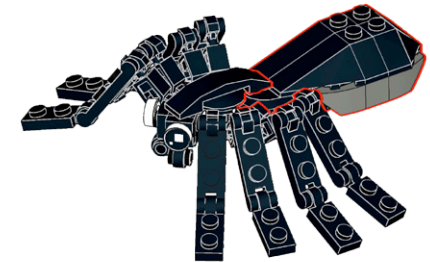
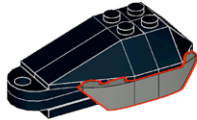

13



SURFING TURTLE



SURFING TURTLE

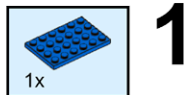

1

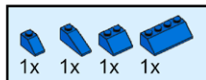
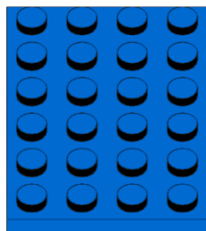

2

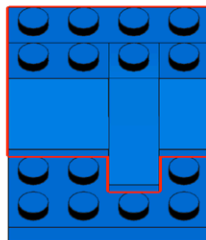

3 4x

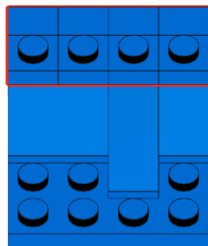

4 3x 1x

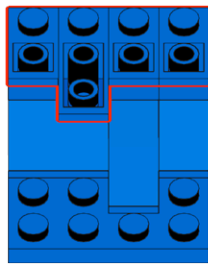

5

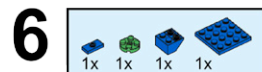
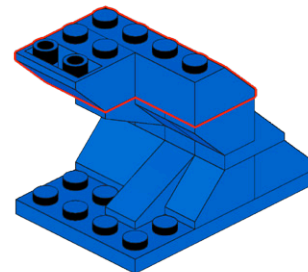

6

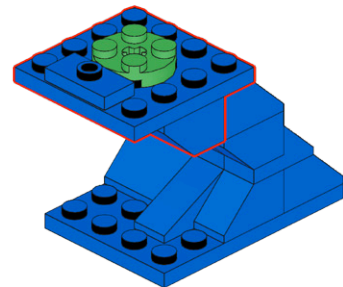

7 4x 1x 1x

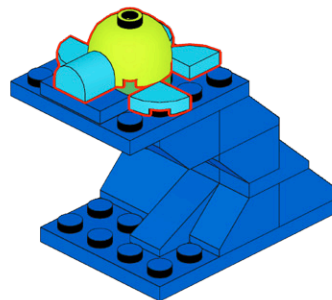

8

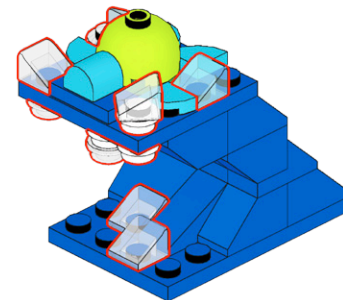

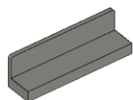

4x
30413, 85



6x
3069b, 7

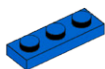

4x
3623, 7

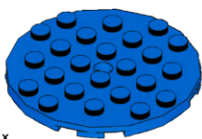

1x
11213, 7

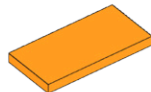

2x
87079, 4



2x
2420, 7

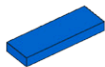

1x
63864, 7



5x
3022, 7

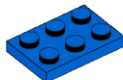

1x
3021, 7

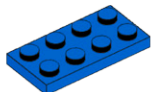

1x
3020, 7



5x
3024, 7



4x
3068b, 7

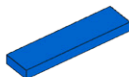

2x
2431, 7



5x
3023, 7

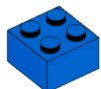

1x
3003, 7



2x
3005, 7

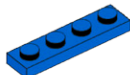

1x
3710, 7

ROBOT ROMANCE



ROBOT ROMANCE

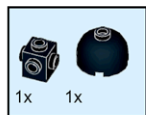

1



2

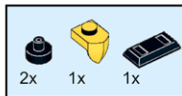
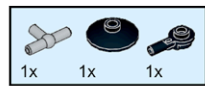

3



4

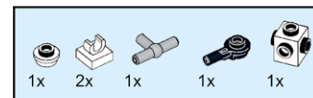

5

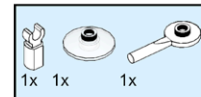

6

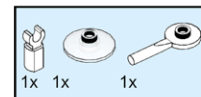
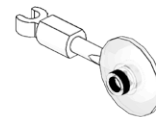

7

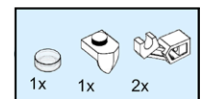
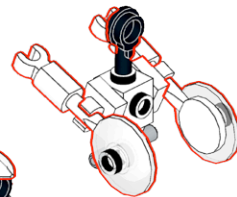

8

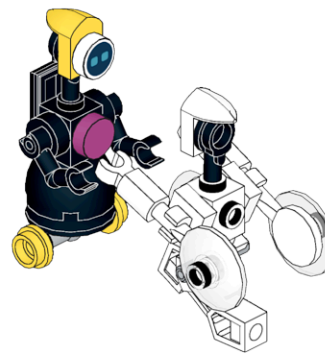
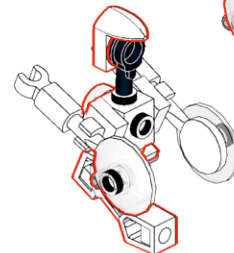

9



2x
20482, 11



1x
4740, 11



2x
93609, 11



2x
11090, 1



2x
98313, 1



2x
85861, 3



2x
4740, 12



2x
32828, 11



1x
553c, 11



1x
4733, 11



1x
15070, 1



2x
15712, 1



1x
15070, 3



2x
3900, 1



1x
99563, 11



2x
4697b, 86



1x
85861, 1



1x
4733, 1



1x
98138pb108, 1



1x
98138, 71



1x
98138, 12

ASTRONAUT



ASTRONAUT

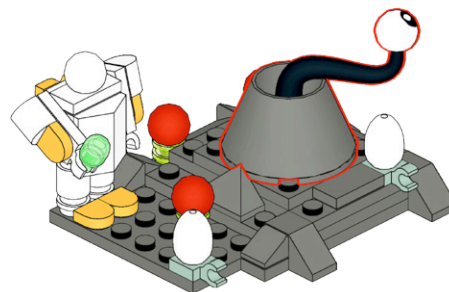
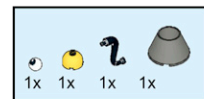
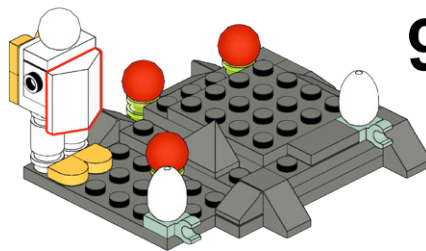
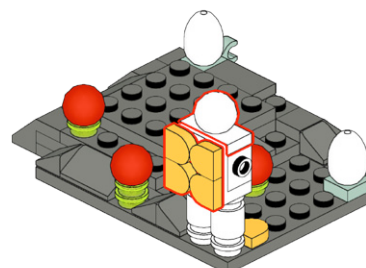
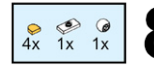
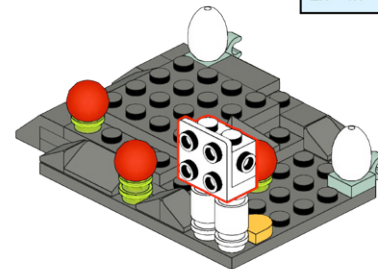
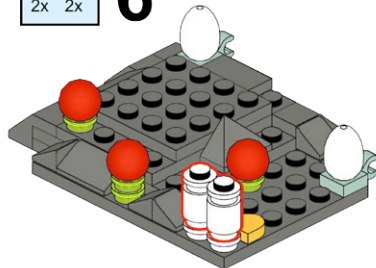
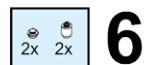
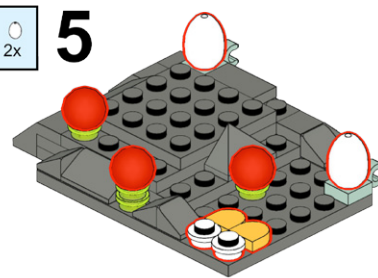
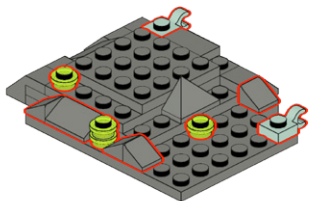
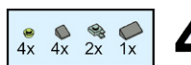
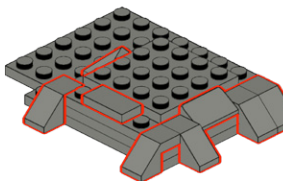
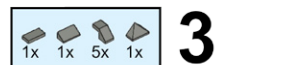
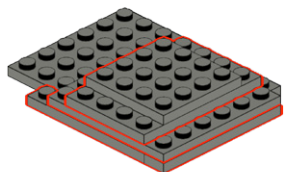
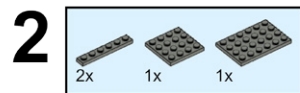
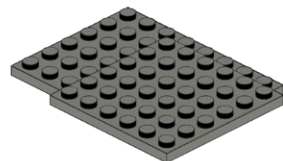
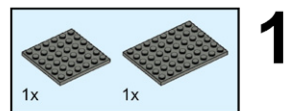

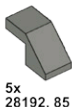

5x
28192, 85

4x
4073, 1

2x
49307, 1

2x
24946, 1

3x
32474, 5

1x
43892, 11



2x
3062b, 1



8x
24246, 110

1x
3794b, 1



4x
54200, 85

1x
3031, 85



1x
32474pb002, 1

1x
3300, 1

1x
553b, 3



1x
3069b, 85



1x
32474, 1

2x
63868, 1

2x
61252, 48



2x
85984, 85

2x
3666, 85



4x
4073, 16



1x
3048c, 85

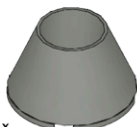

1x
4742, 85

2x
26604, 1

1x
99207, 1

1x
58176, 108



1x
3032, 85

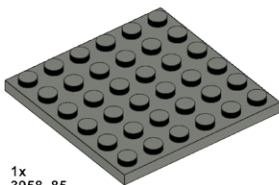

1x
3958, 85

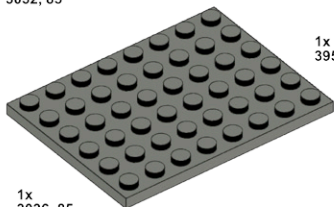

1x
3036, 85

SKULL

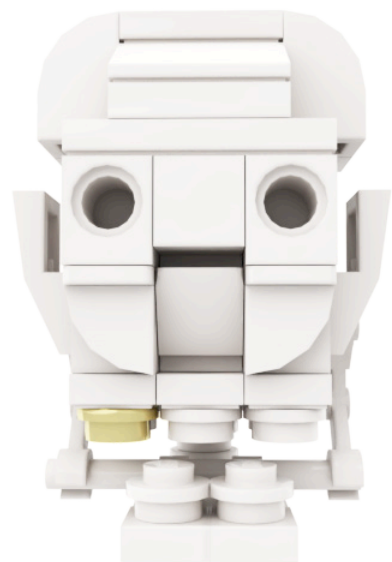

SKULL

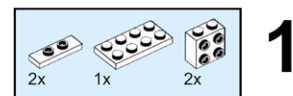

1

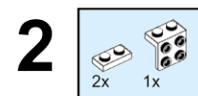
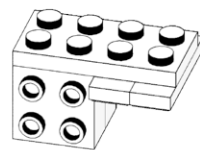

2

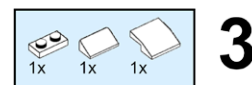
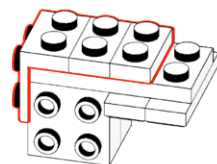

3

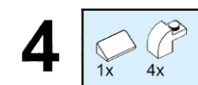
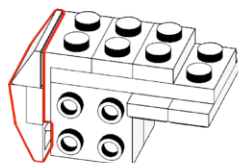

4

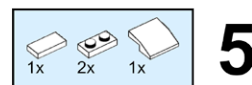
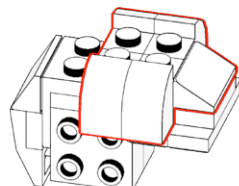

5

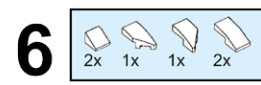
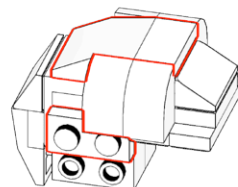

6

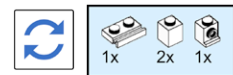
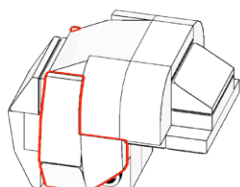

7

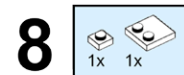
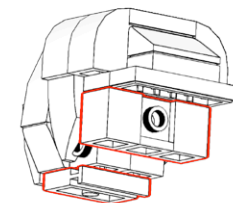

8

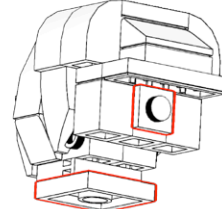

9

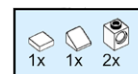
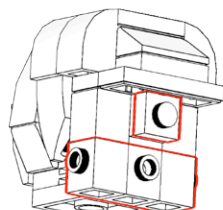

10

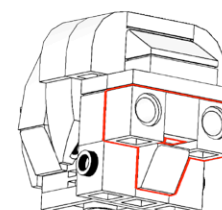

11

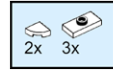
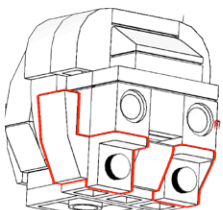
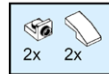

12



13

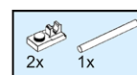
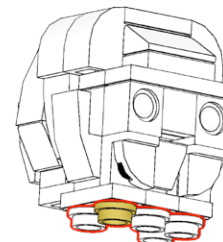

14

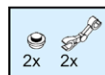
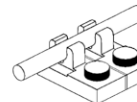

15

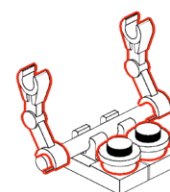

16

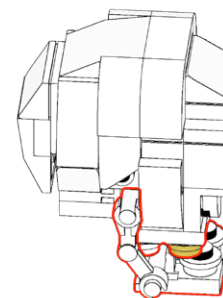

17

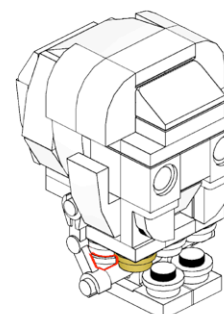



1x
3070b, 1



2x
25269, 1



2x
85861, 1



9x
4073, 1



2x
3024, 1



3x
54200, 1



2x
6541, 1



2x
3005, 1



2x
36840, 1



1x
4070, 1



3x
87087, 1



1x
3069b, 1



1x
29120, 1



1x
29119, 1



5x
3023, 1



3x
3794b, 1



2x
85984, 1



4x
11477, 1



2x
92280, 1



1x
32028, 1



4x
6091, 1



2x
30377, 1



2x
15068, 1



1x
33909, 1



2x
34103, 1

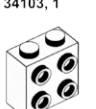

2x
22885, 1



1x
44728, 1



2x
30374, 1



1x
3020, 1



1x
4073, 21

TORTOISE

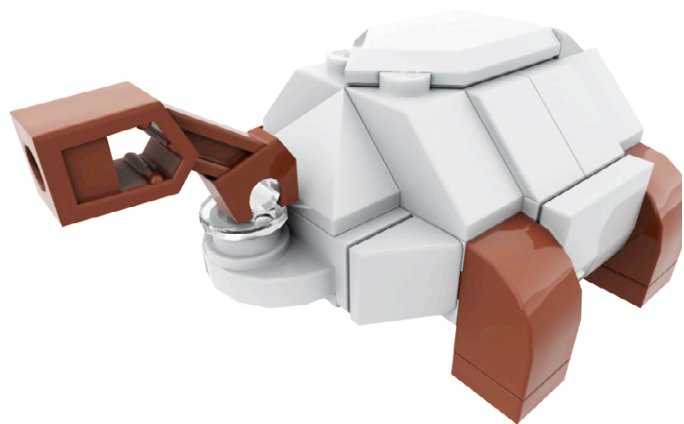
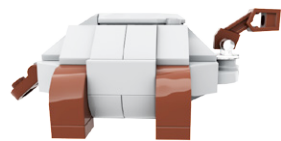

TORTOISE

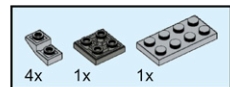

1



2

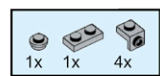
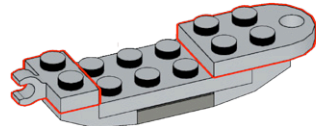
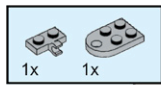

3

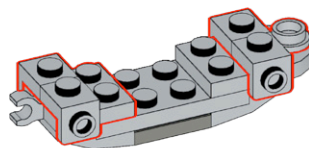

4

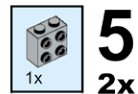
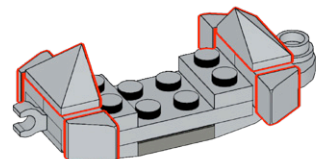
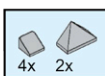

5

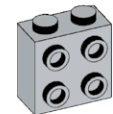

6

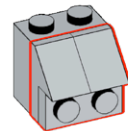
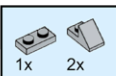

7

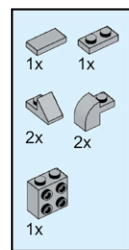
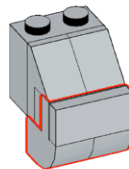
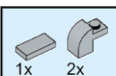

8

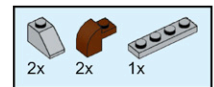
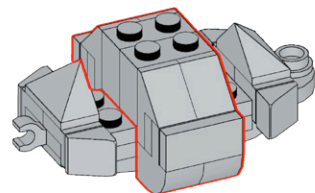

9

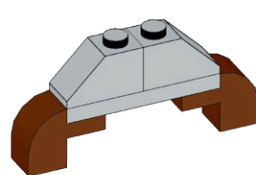

10

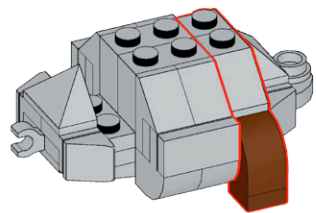
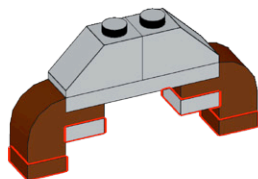

11

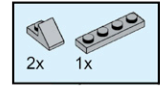

12

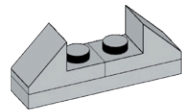

13

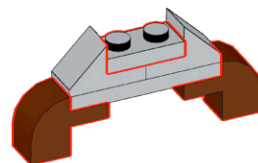
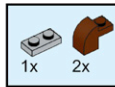

14

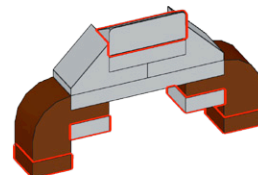
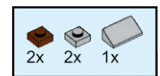

15

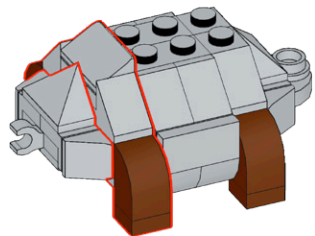

16

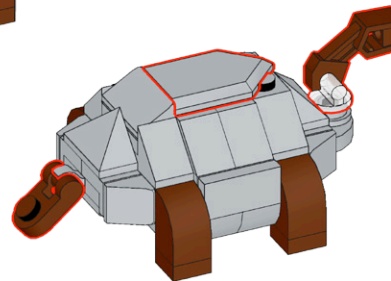
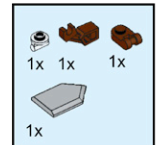



1x
11203, 85



4x
3024, 86



1x
4073, 86



4x
54200, 86



4x
36841, 86



2x
3069b, 86



4x
3023, 86



1x
85984, 86



4x
24201, 86



2x
3048c, 86



6x
92946, 86



2x
3040, 86



1x
11476, 86



4x
6091, 86



2x
22885, 86

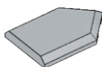

1x
22385, 86



1x
3176, 86

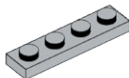

2x
3710, 86

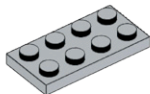

1x
3020, 86



1x
26047, 88



4x
6091, 88



1x
98313, 88



1x
79194, 12



4x
3024, 88

DRAGON



DRAGON

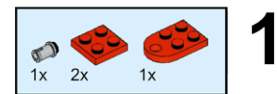

1

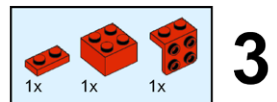
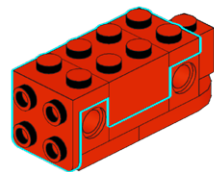
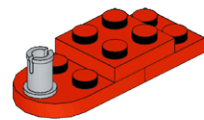

3

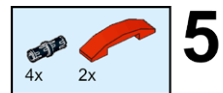

5

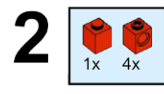
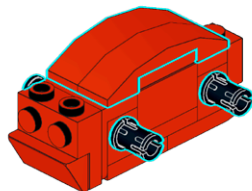

2

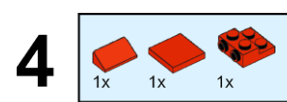
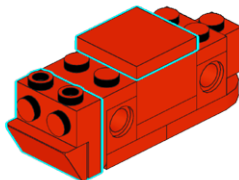
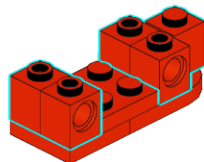

4

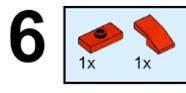

6

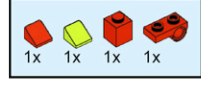
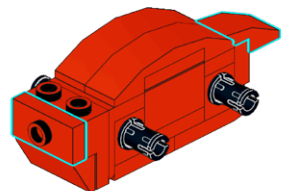

7

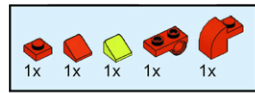
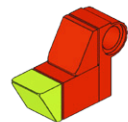

9

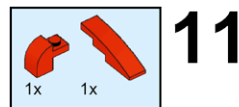
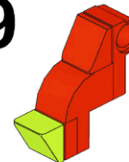

11

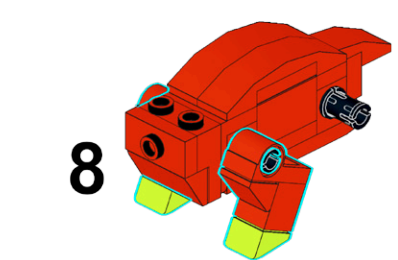
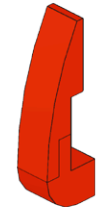

8

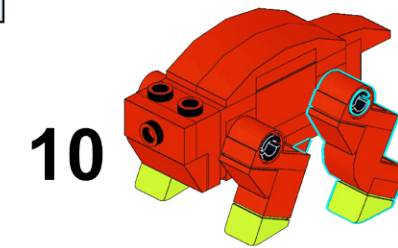

10

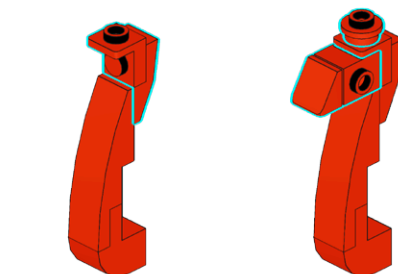

12

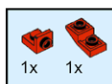

13

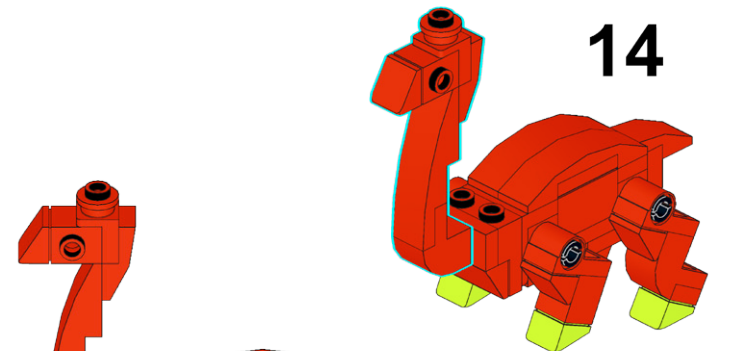
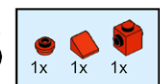

14

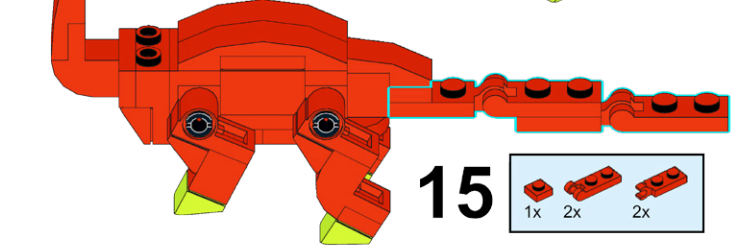

15

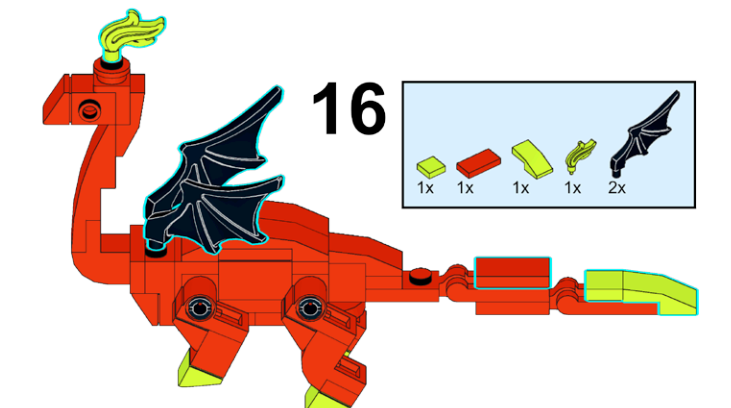

16

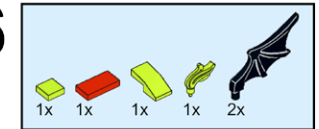

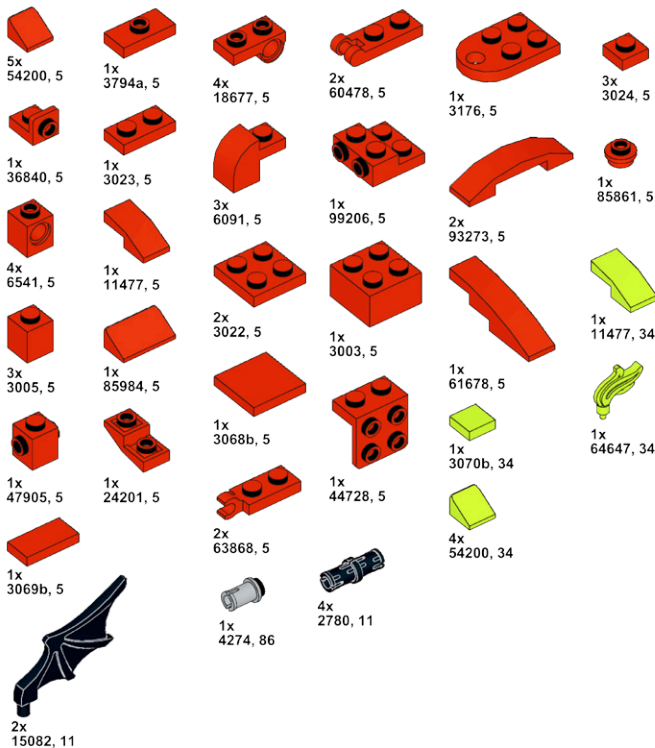

CHRISTMAS TREE



CHRISTMAS-TREE

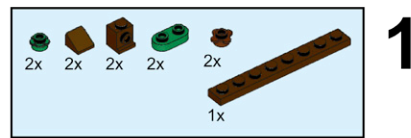

1

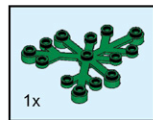

2

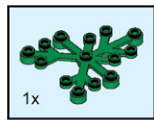
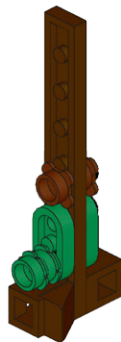

3

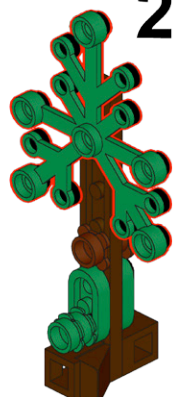

5

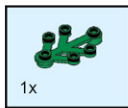
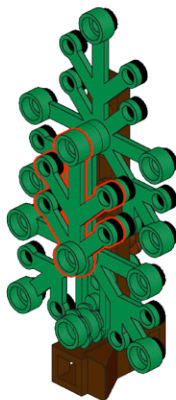

4

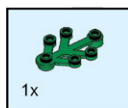

1x

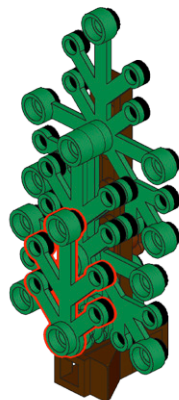

6

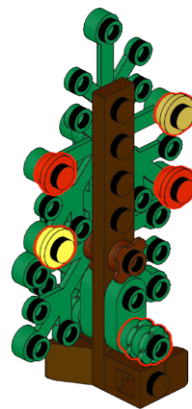

7

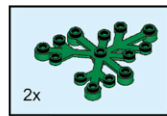

9

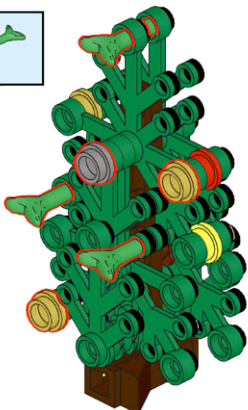

8



2x



10

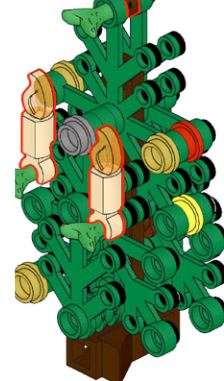

11



12

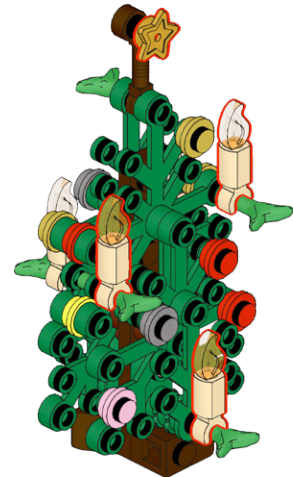



1x
4073, 104



4x
4073, 5



2x
33291, 88



2x
54200, 120



2x
4070, 120



1x
4735, 120



4x
4073, 21



2x
4073, 95



5x
11090, 2



1x
4073, 103



4x
24866, 6



2x
35480, 6



6x
33183, 36



5x
37775, 98



1x
11609, 115

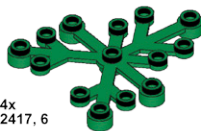

4x
2417, 6



4x
2423, 6

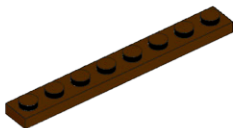

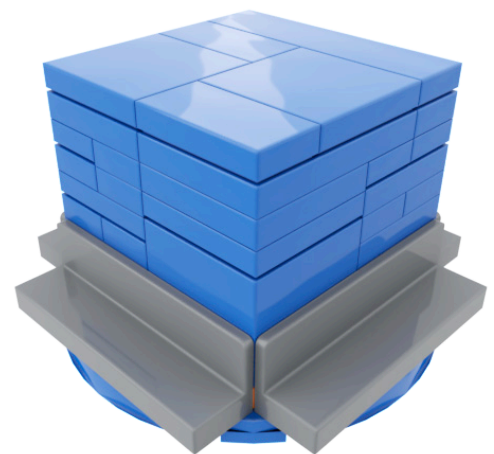
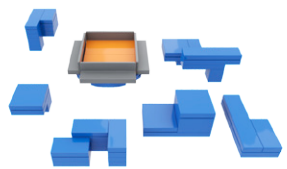

1x
3460, 120

PUZZLE CUBE



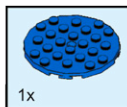

PUZZLE CUBE

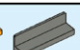

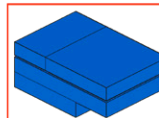
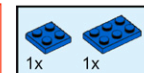
1  1x

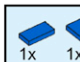

2  2x  4x

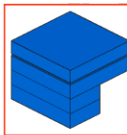
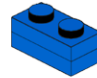
3  1x  1x

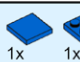
4  1x  1x

5  2x  1x

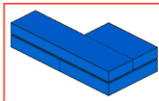

6  1x  1x

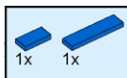
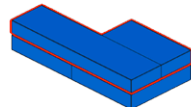
7  2x  1x  1x

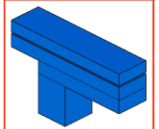
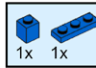
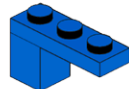
8  1x  1x

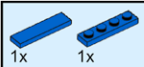
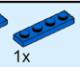
9  1x  1x  1x

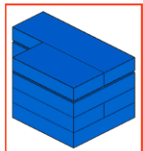
10  1x  1x

11  1x  1x

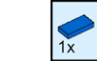

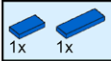
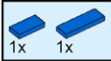
12  1x  1x

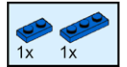
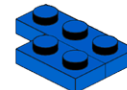
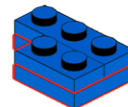
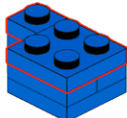
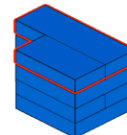
13  1x  1x

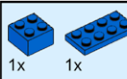
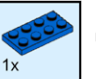
14  1x  1x  1x  1x  1x

15  1x  1x

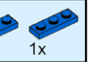
16  2x

17  1x  1x  1x

18  2x

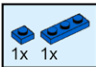
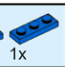
19  1x  1x

20  3x

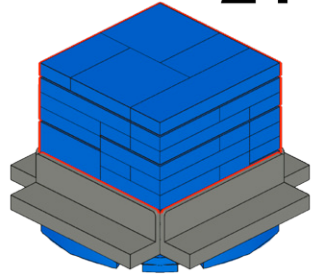
21 

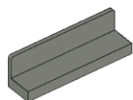

4x
30413, 85



6x
3069b, 7

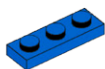

4x
3623, 7

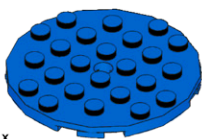

1x
11213, 7

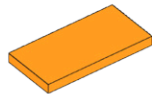

2x
87079, 4



2x
2420, 7

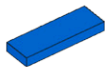

1x
63864, 7



5x
3022, 7

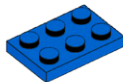

1x
3021, 7

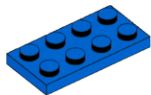

1x
3020, 7



5x
3024, 7



4x
3068b, 7

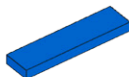

2x
2431, 7



5x
3023, 7

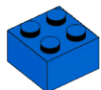

1x
3003, 7



2x
3005, 7

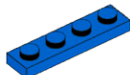

1x
3710, 7

SANTA



SANTA

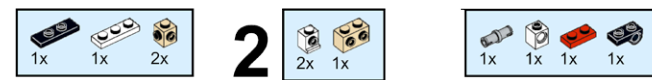

1

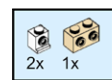
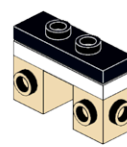

2

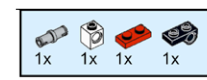
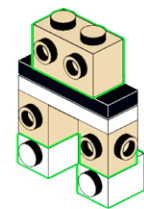

3

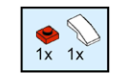
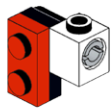

4

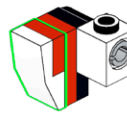

5

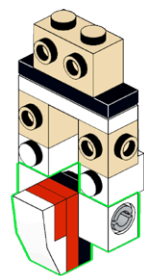

6

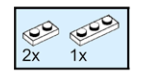
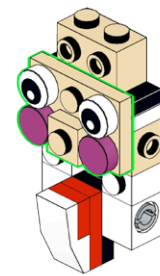

7

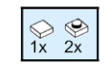
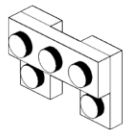

8

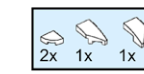
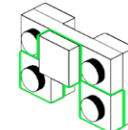

9

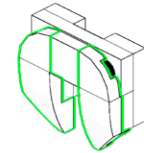

10

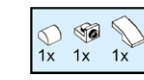
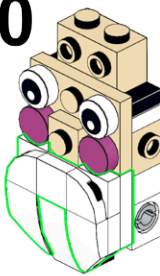

2x 11

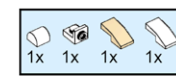

12

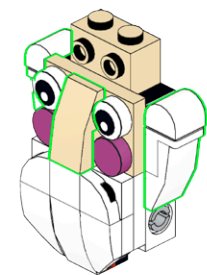

13



14 15

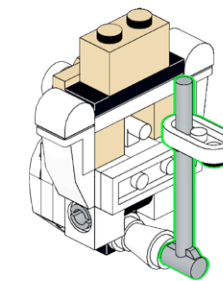
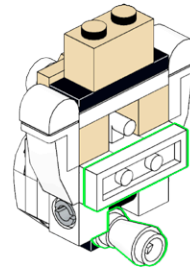
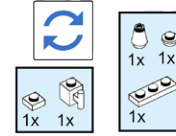

16

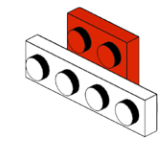
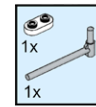

17

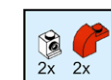
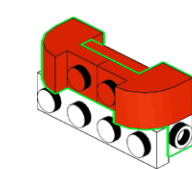
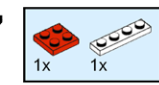

18

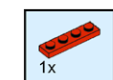
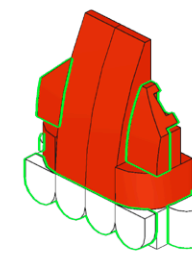

19

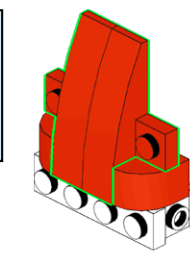

20



21

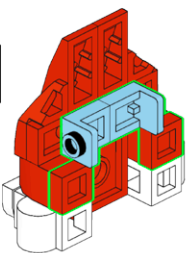

22

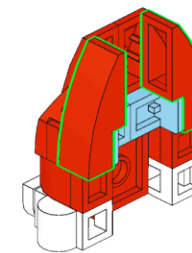

23

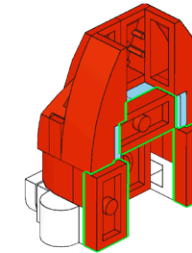

24

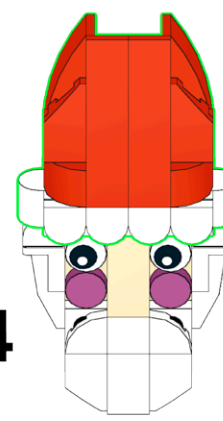



1x
18677, 11

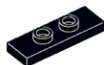

1x
34103, 11



1x
3673, 86

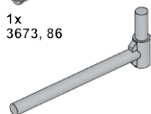

1x
87618, 86

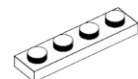

1x
3710, 1



1x
2815, 1



1x
3024, 2



2x
26604, 2

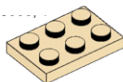

1x
3021, 2



2x
98138, 71



2x
98138pb007, 1



2x
25269, 1



4x
24246, 1



1x
4073, 1



3x
3024, 1



4x
49307, 1

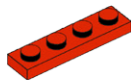

1x
3710, 5



4x
3023, 5



2x
6091, 5



1x
11211, 2



1x
11477, 2



2x
36840, 1



1x
6541, 1



1x
4589b, 1



4x
4070, 1



1x
29120, 1



1x
3022, 5



1x
29119, 5



2x
36841, 105



1x
29119, 1



2x
3023, 1



1x
35480, 1



1x
2921, 1



3x
11477, 1

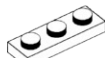

3x
3623, 1



1x
3070b, 1



1x
3005, 1



3x
3024, 5



1x
29120, 5



2x
50950, 5

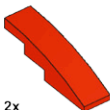

2x
61678, 5

3D-LABYRINTH

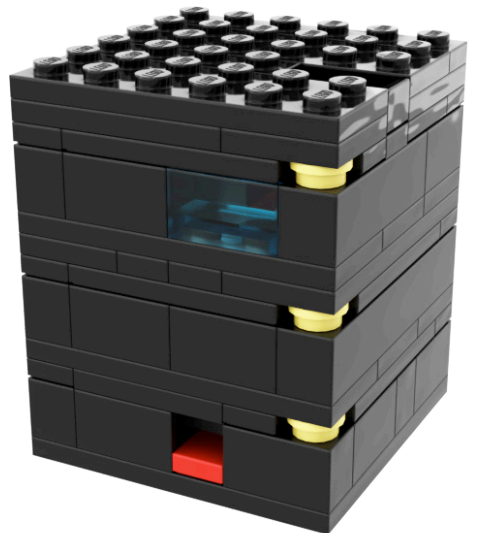

3D LABYRINTH

1 **2**

1x 2x 1x 1x 1x 4x 1x

LEVEL 1

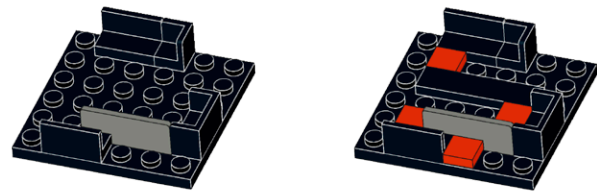

3 **4**

1x 2x 1x 1x 1x 3x 1x 1x 1x 1x 2x 1x

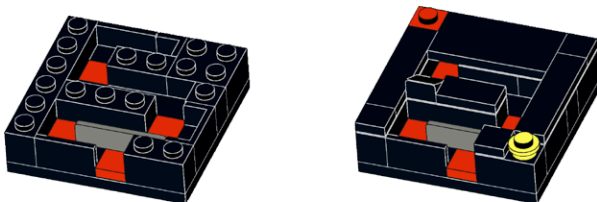

5 **6**

1x 1x 2x 1x 1x 1x

LEVEL 2

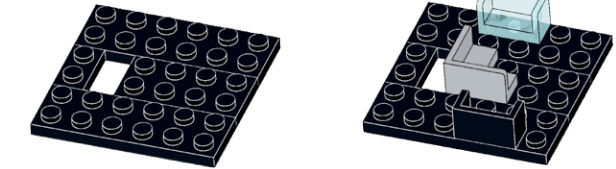

7 **8**

1x 1x 1x 1x 1x 1x 1x 1x 1x

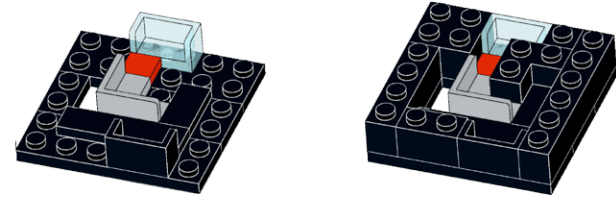

9 **10**

3x 1x 1x 1x 3x 1x 1x

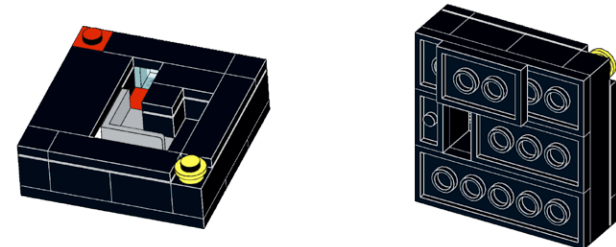

11 **12**

1x 1x 1x 2x 1x 2x 2x

LEVEL 3

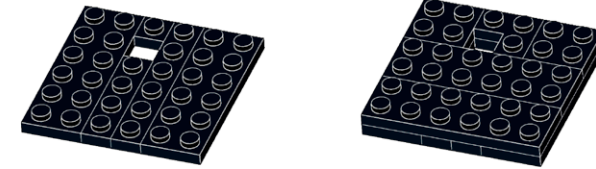

13 **15**

3x 1x 3x 1x 2x 2x 1x 2x

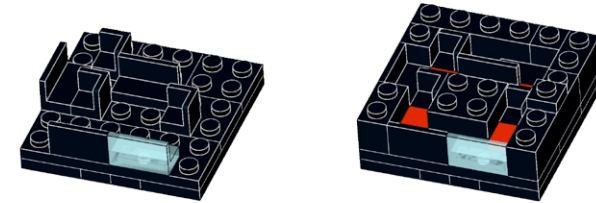

14 **16**

4x 1x 3x 1x 1x 1x 2x 2x 1x

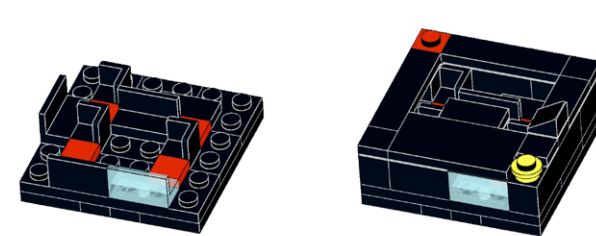

17 **18**

1x 1x 1x 1x 1x 2x

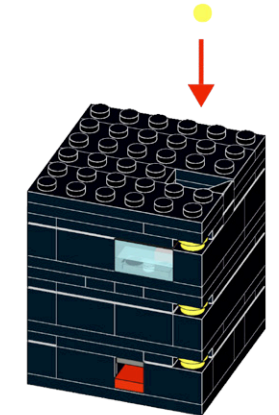

... 19

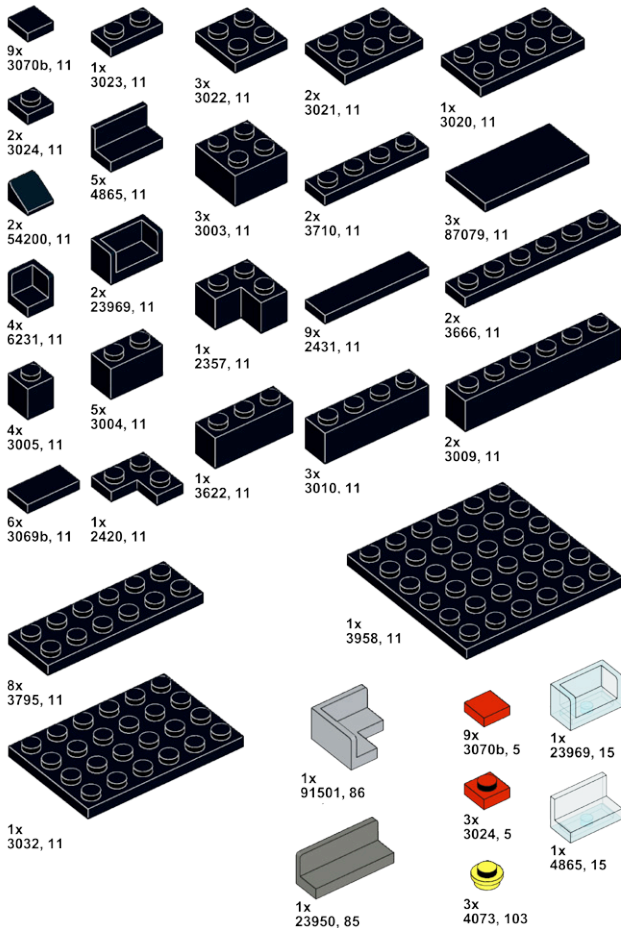

SBC

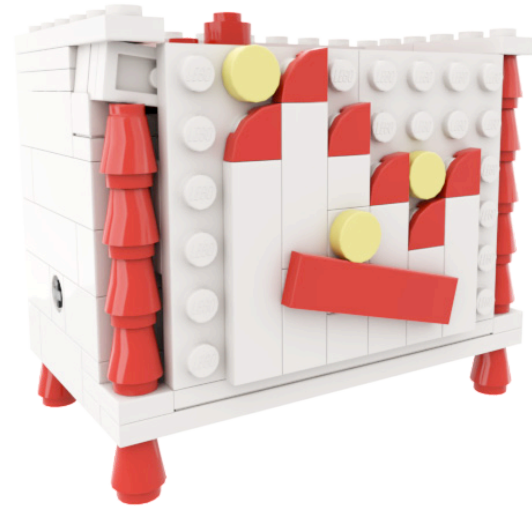
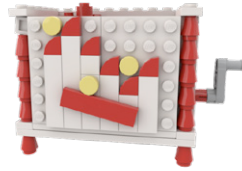

SBC

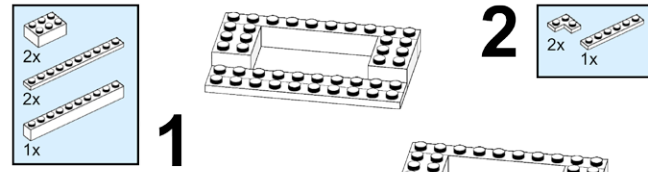

1



3

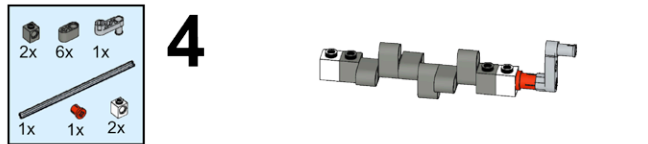

4

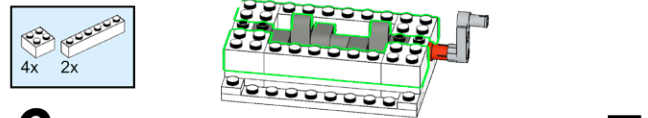

6



2

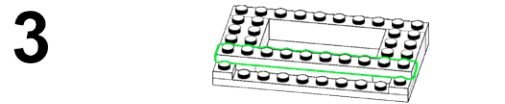

5

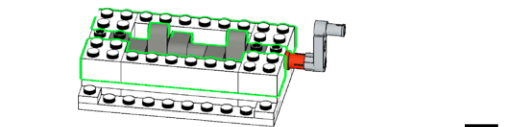

7



9

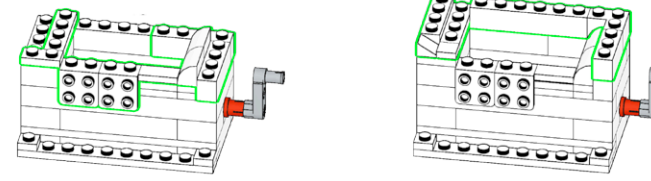

11

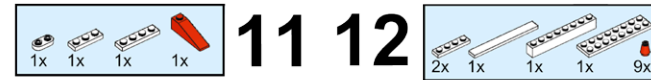

12

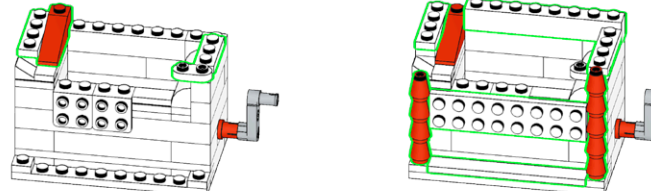

13

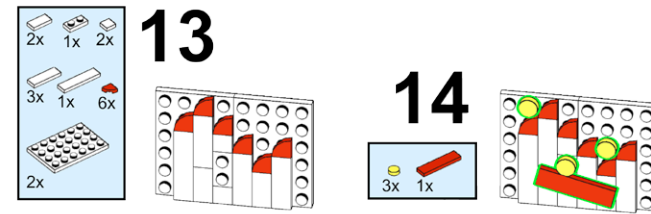

14

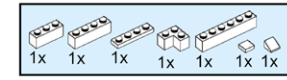

10

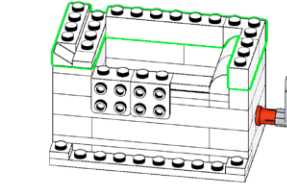

12

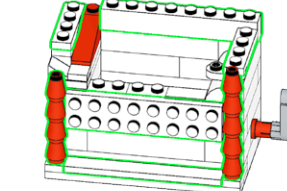

14

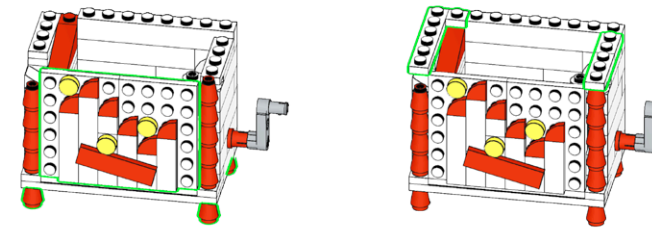

15

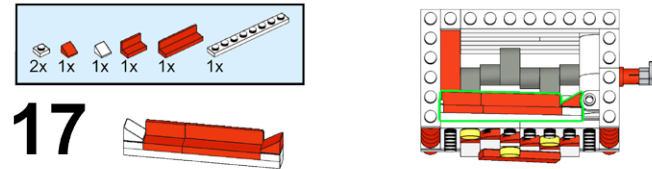

17

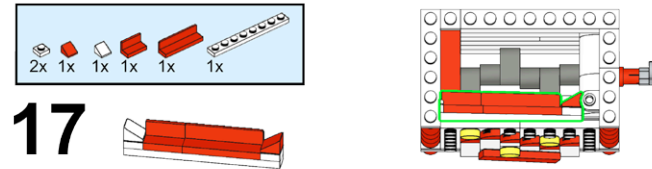

16

18

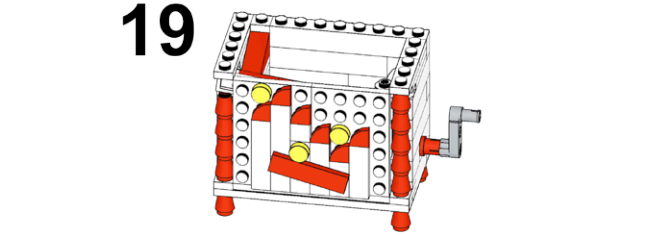

19

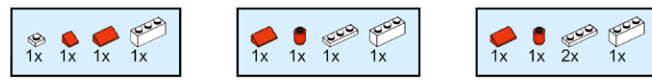

20

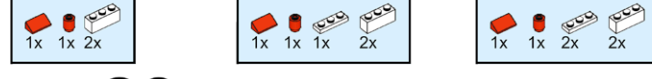

23



26

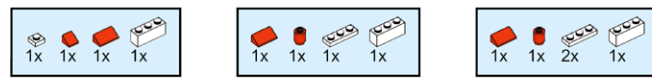

21

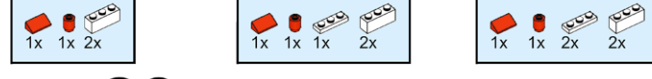

24



27

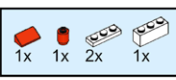

22

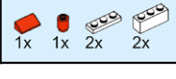

25

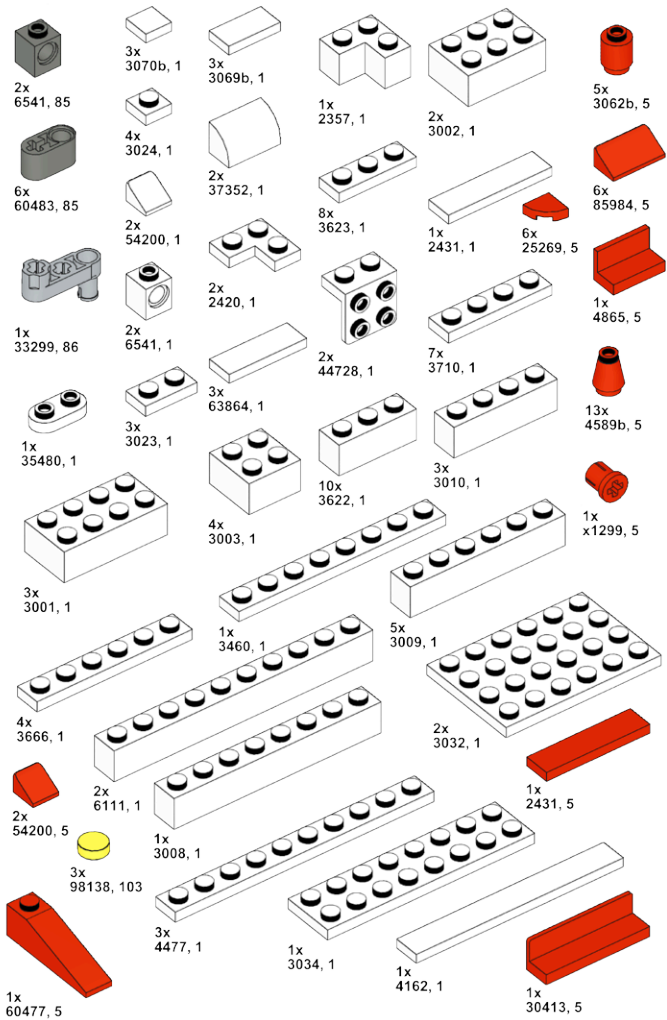

3D-MAZE

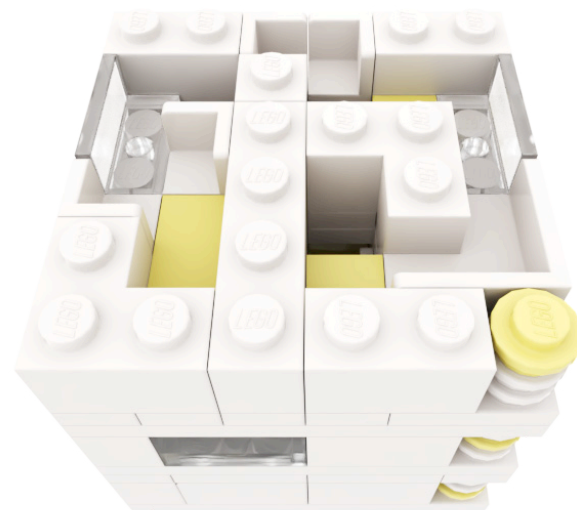
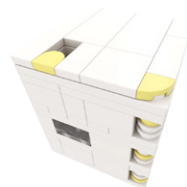

3D MAZE

1 1x

2 1x 1x 2x 1x

3 2x 1x 1x 1x

4 1x 5x

5 2x 1x 1x

6

7 2x 1x 1x 1x 1x 1x 2x

8 1x 2x 1x 1x 2x

9 2x 2x

10 4x 1x 3x

11 2x 3x 2x

12 2x 1x

13 3x 1x 2x 2x

14 3x 1x 1x 2x 1x

15 2x 1x

16 4x 2x 1x

17 1x 3x 2x 1x

18 2x 1x

19 1x 1x 1x

20 1x 1x 2x 1x

21 1x 1x 2x 1x 1x 2x 1x

22 ...

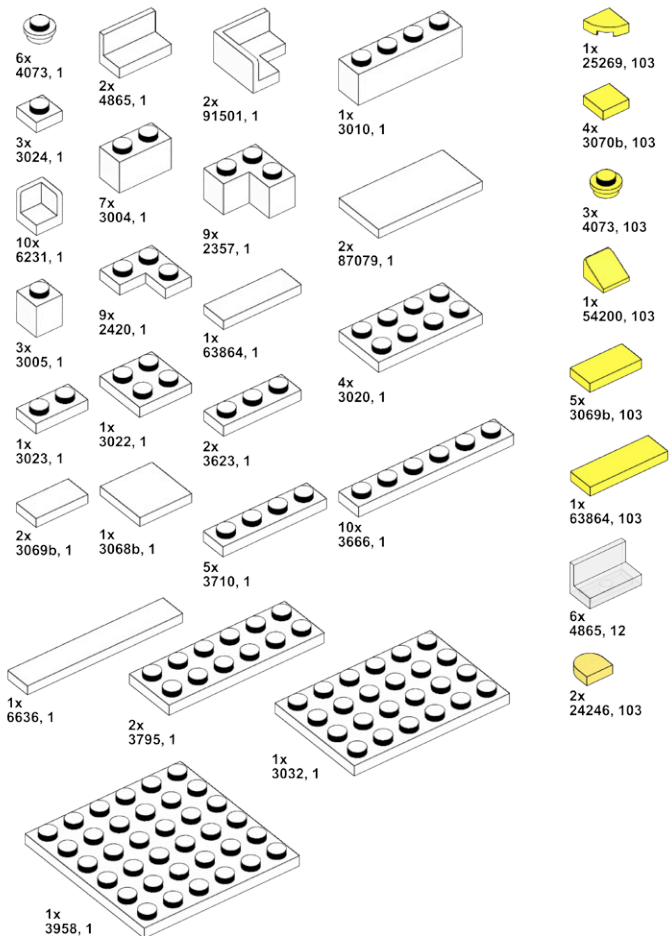

MONEYBIN

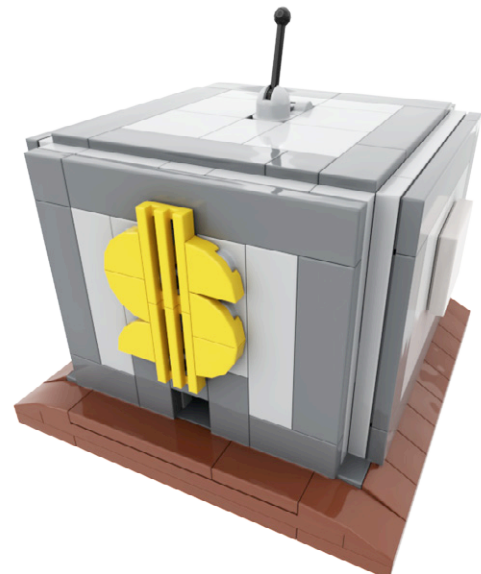
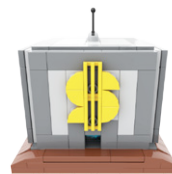

MONEYBIN

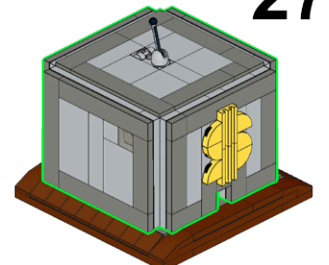
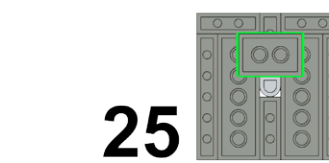
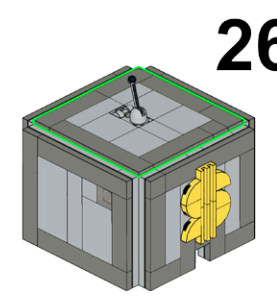
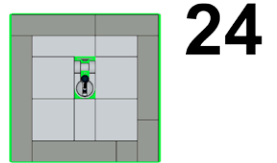
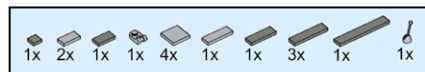
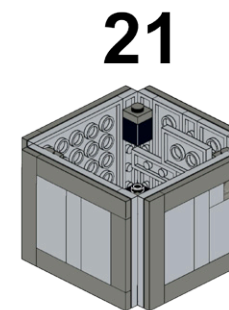
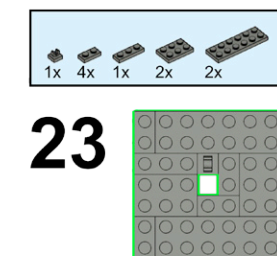
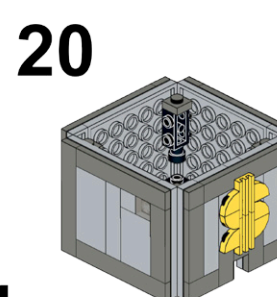
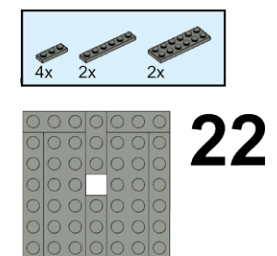
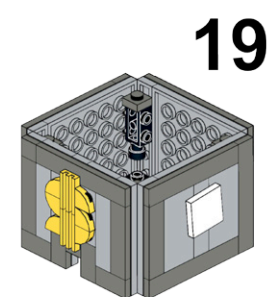
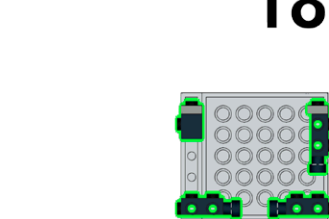
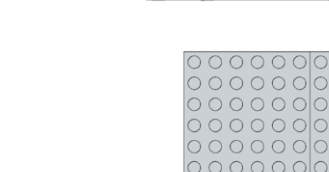
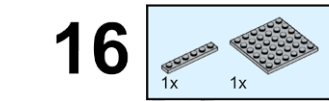
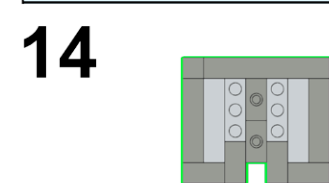
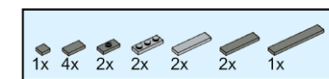
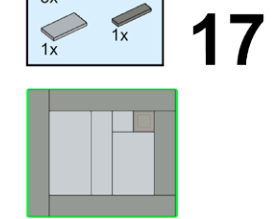
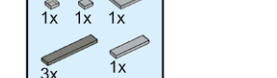
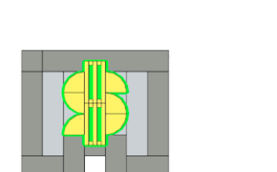
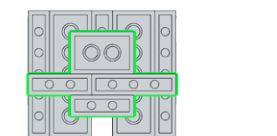
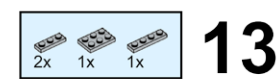
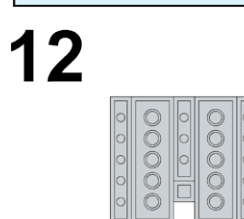
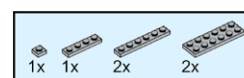
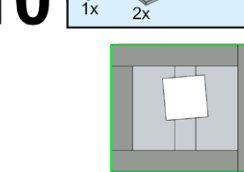
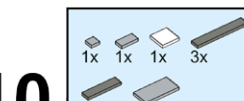
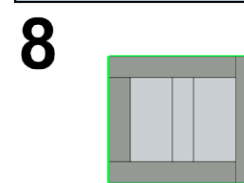
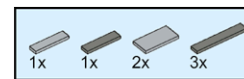
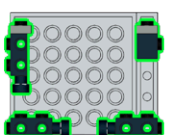
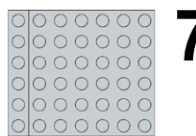
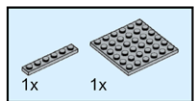
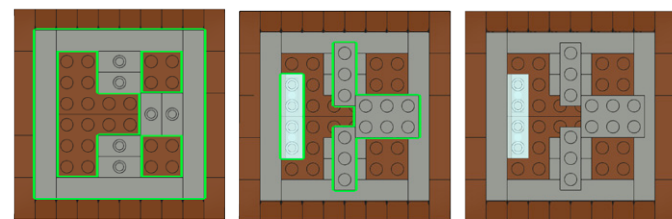
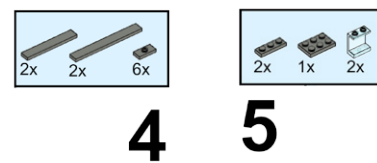
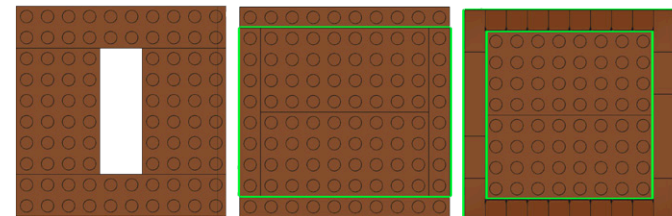
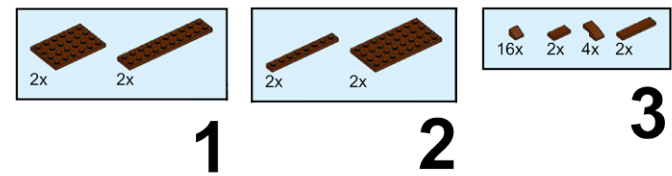

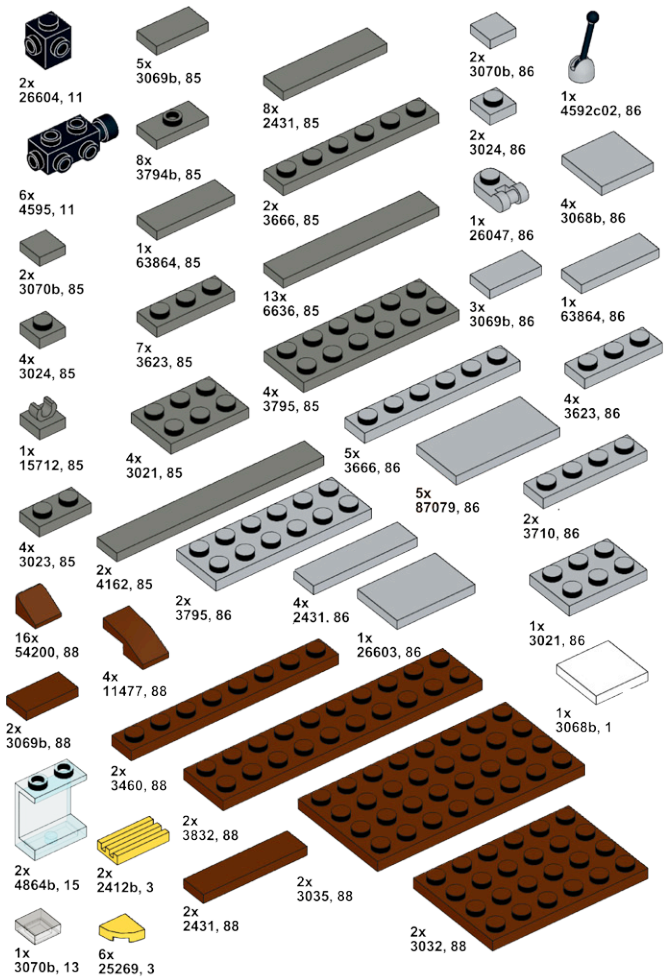

Crow

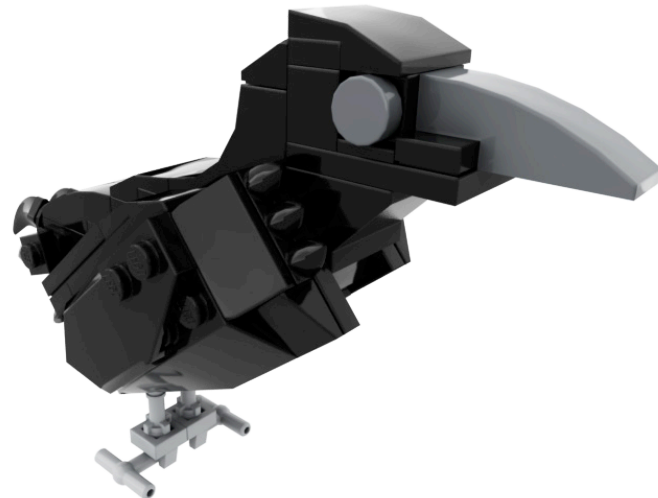

Crow

1 1x 1x

2 1x 1x 1x

3 1x 1x 1x

4 1x 2x 1x

5 2x 2x 1x

6 2x 1x

7 1x 2x 1x

8 1x 1x 2x

9 1x 2x 1x

10 1x 1x 1x 1x

11 2x 2x 2x 2x

12 2x 2x 2x

13 1x

14 1x 1x

15 1x 1x 1x 1x 1x

16 1x 1x

17 1x

18 1x 1x 1x 1x

19 1x 1x 1x 1x 1x

20 1x 1x 1x 1x

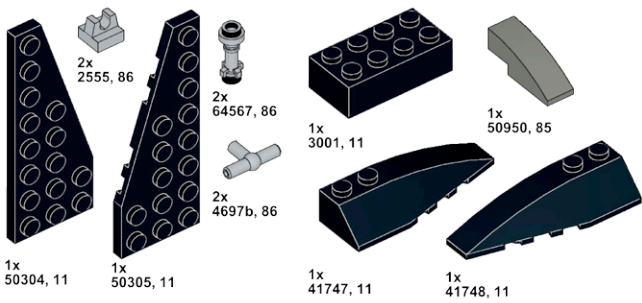
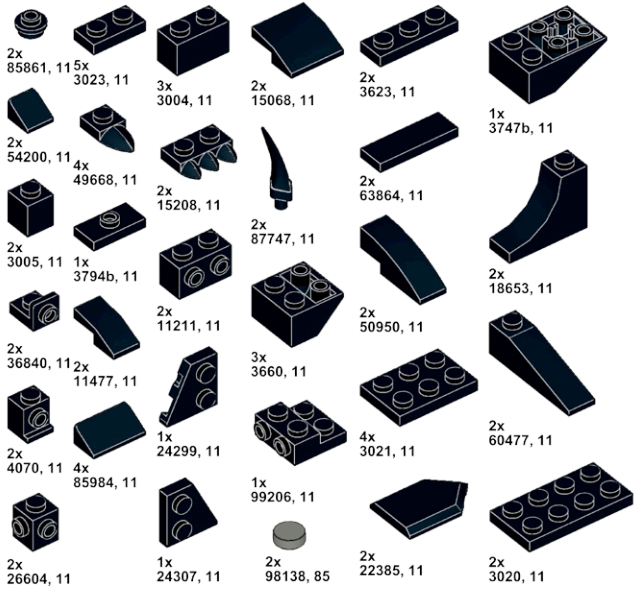

DANCING ALIENS

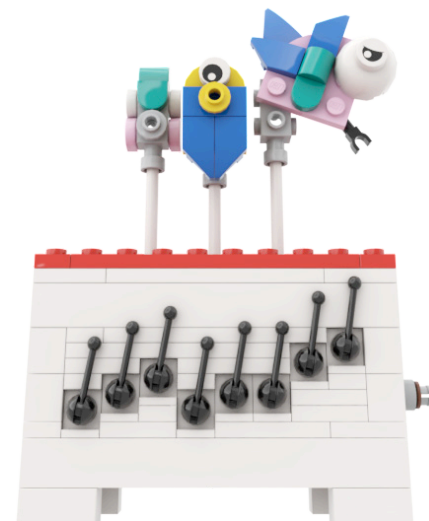
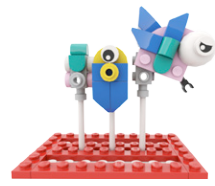

DANCING ALIENS

1 4x 2x 2x

2 2x 1x 1x 1x

3 2x 2x 1x

4 1x 1x 1x

5 1x 1x 1x

6 1x 1x 1x 1x

7 2x 1x 1x 2x 1x

8

9 2x 1x

10 2x 3x 1x

11 8x

12 2x 1x 1x

13 1x 2x

14 2x 3x 2x

16 2x 2x 1x 1x

17 1x 1x 1x 1x

18 1x 1x 1x 3x

19 1x 2x 2x 1x 1x 1x

20 1x 1x

21 1x 1x 1x

22 1x 1x 1x 1x

23 8x 1x

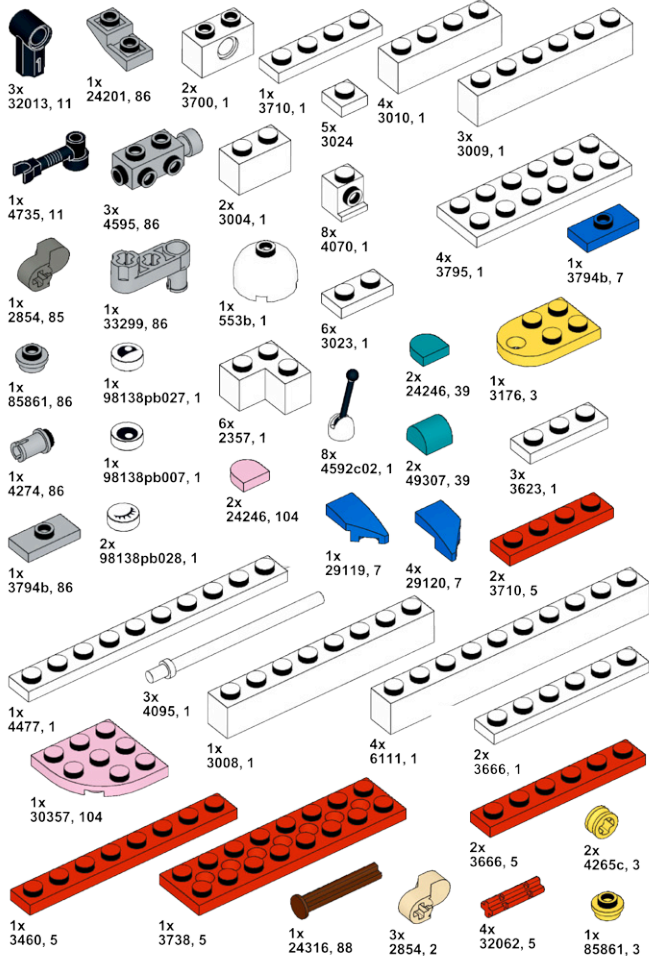

ECTO-1



ECTO-1

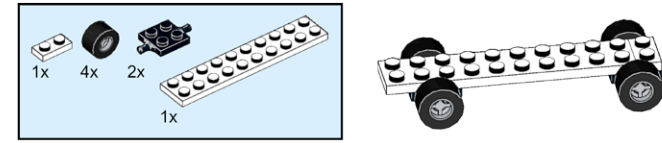

1

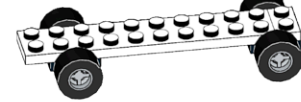

2

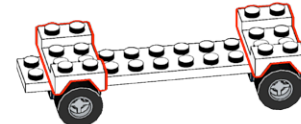

3

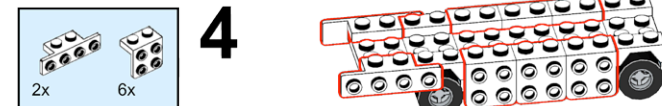
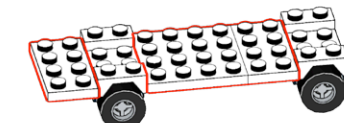

4

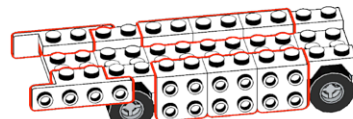

5

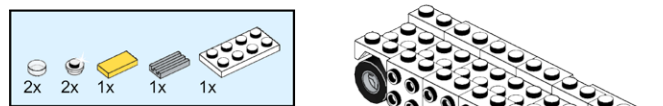
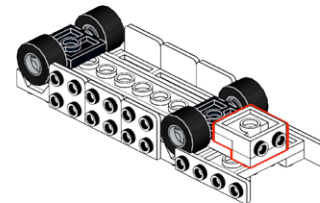

6

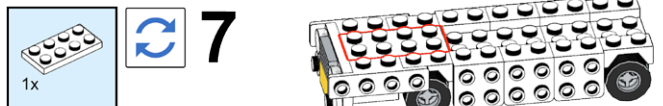
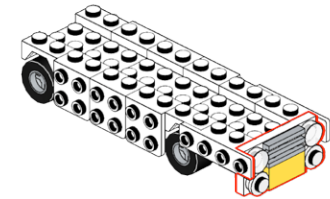

7

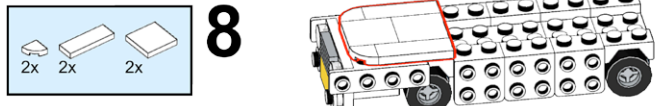
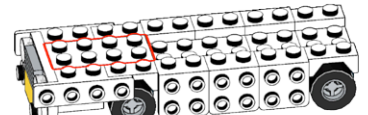

8

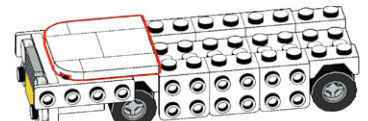

9

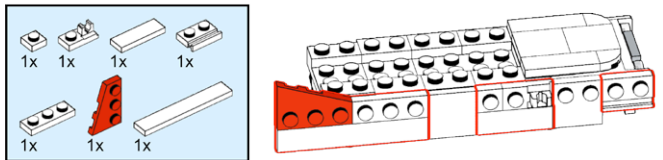
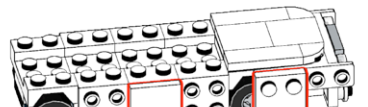

10

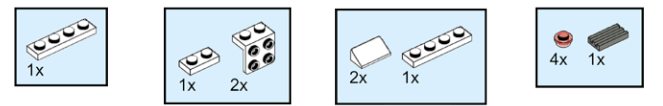
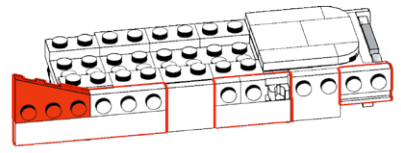

11

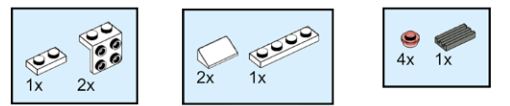

12

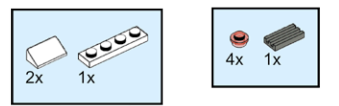

13

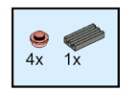

14

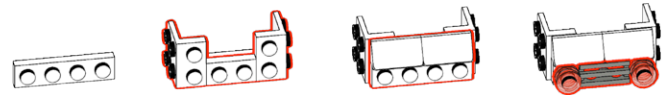

15

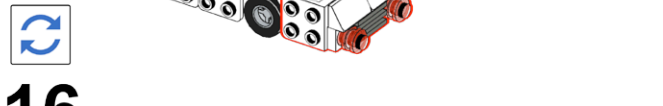
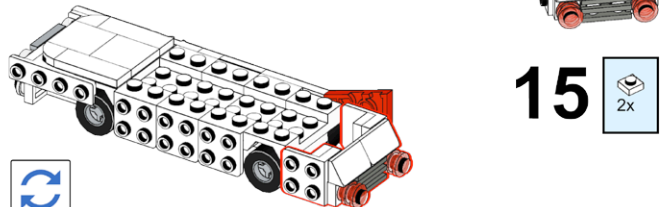

16

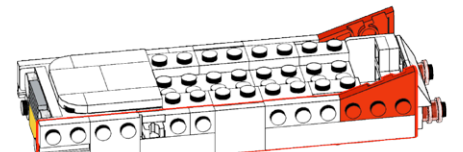

17

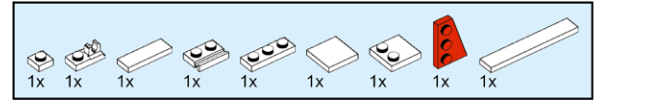

18

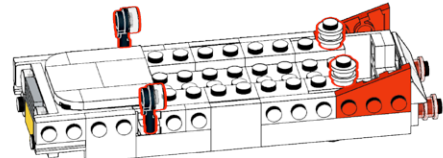

19

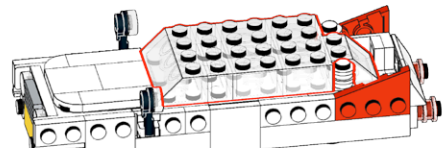

20

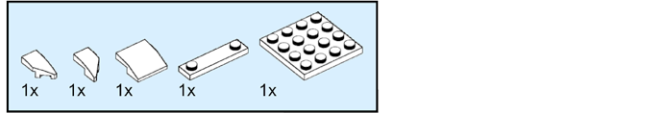
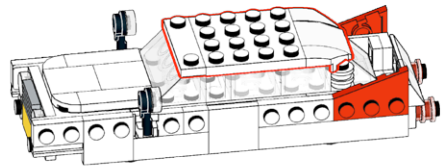

21

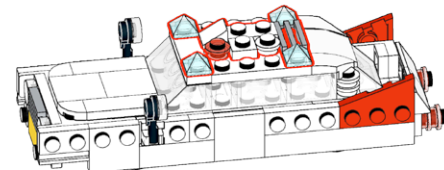

22

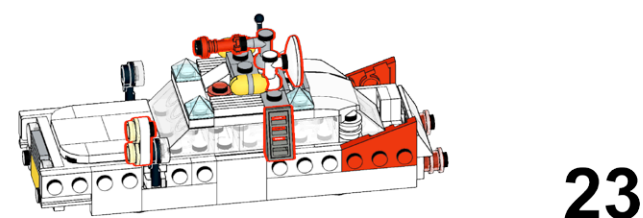
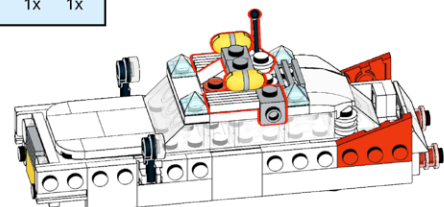

23

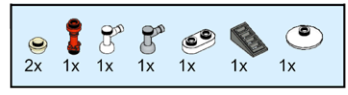

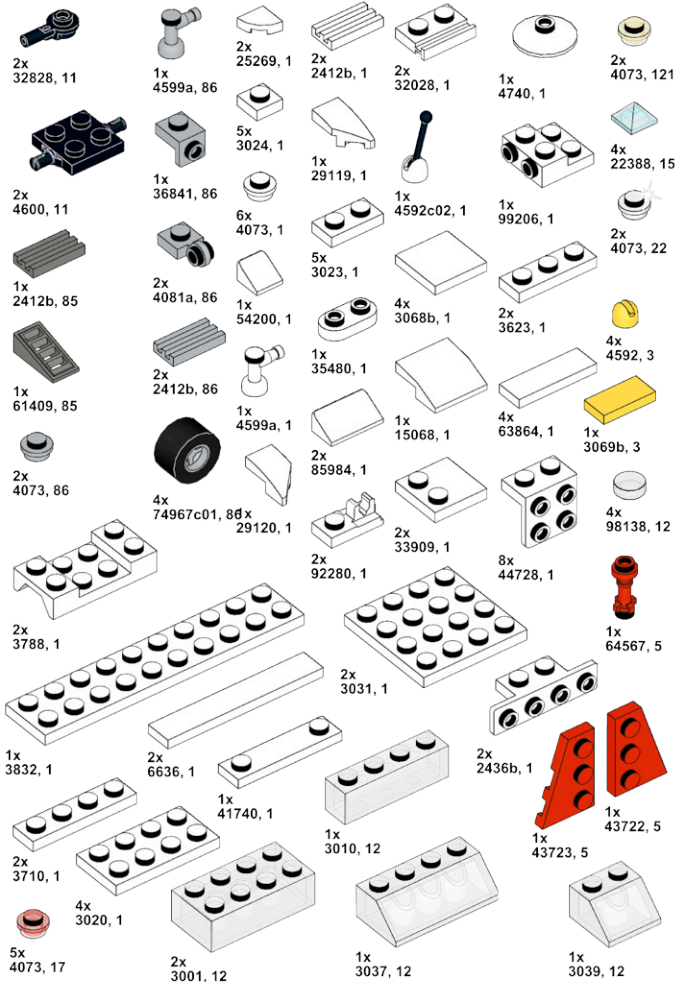

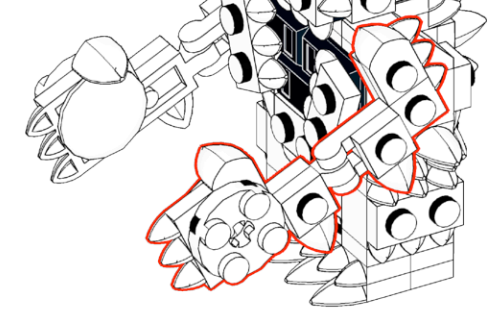
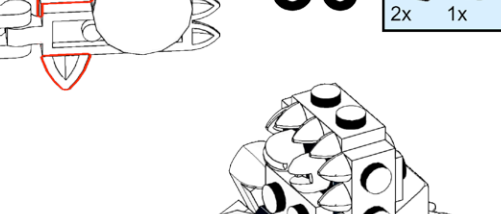
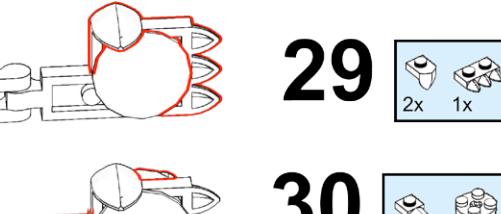
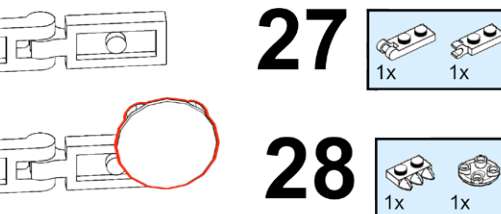
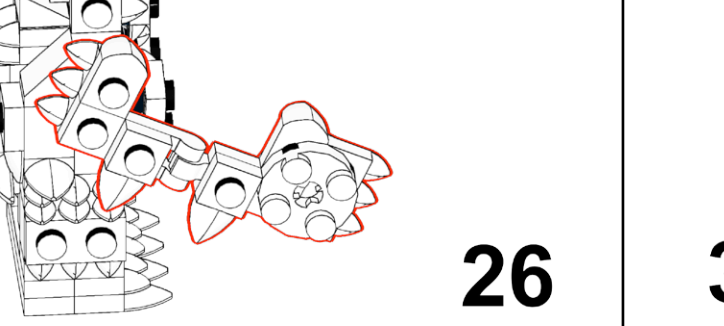
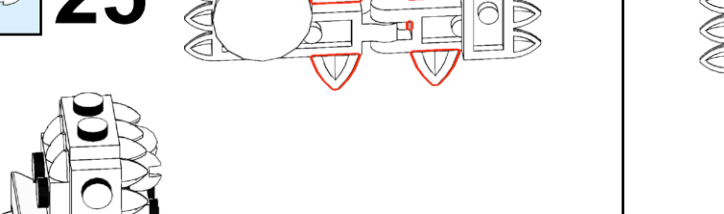
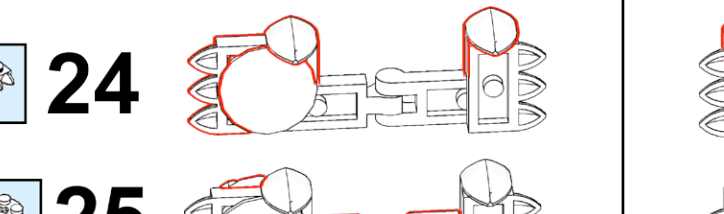
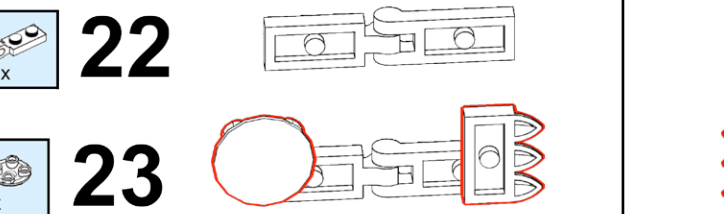
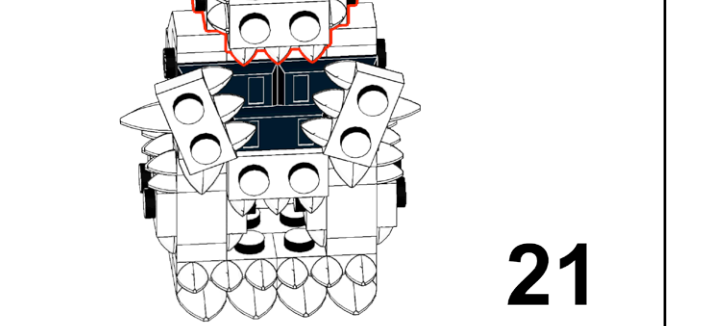
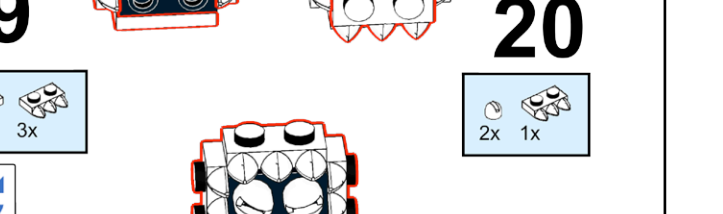
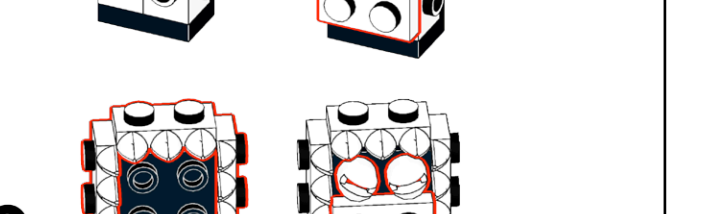
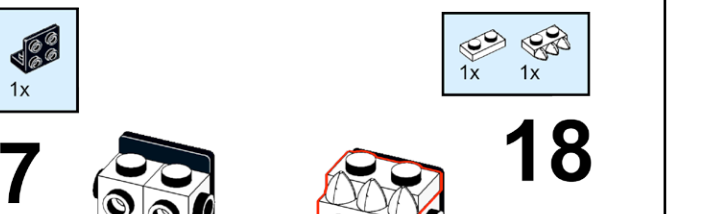
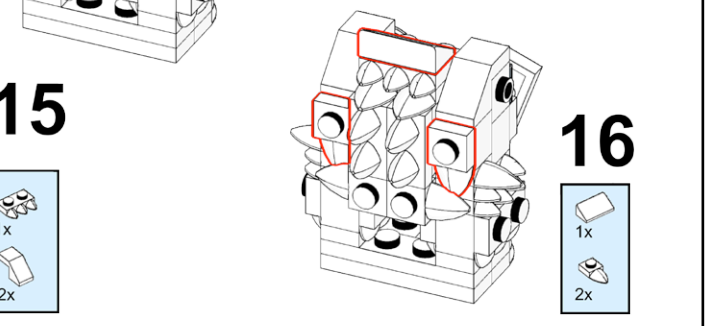
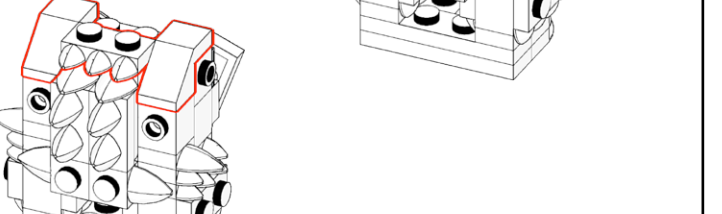
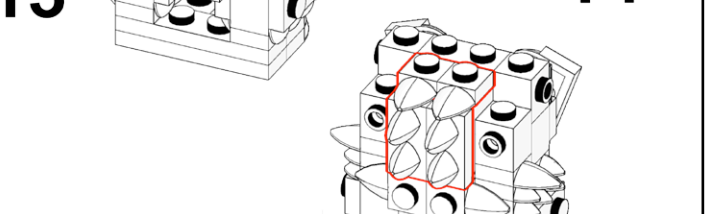
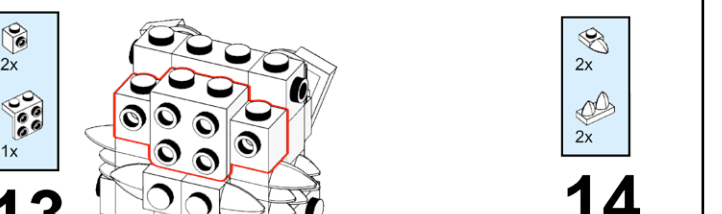
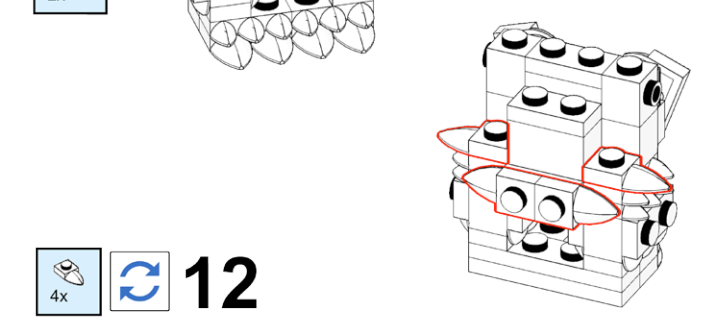
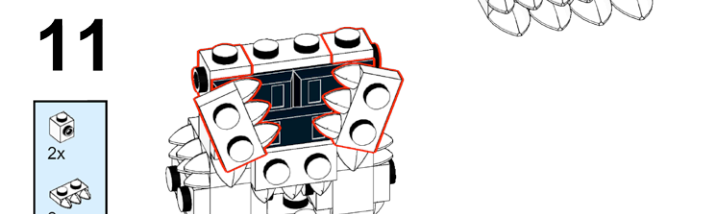
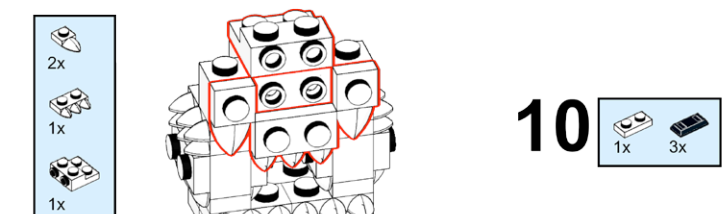
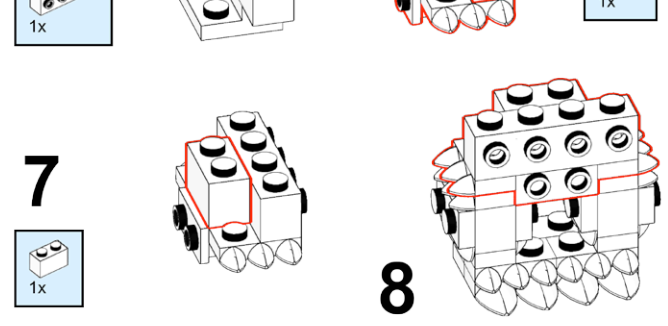
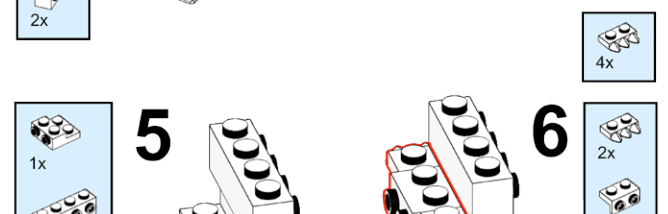
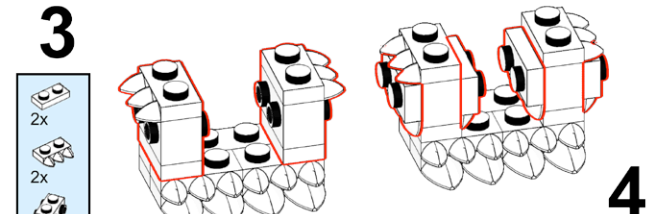
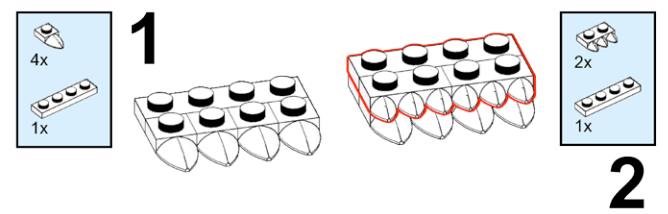
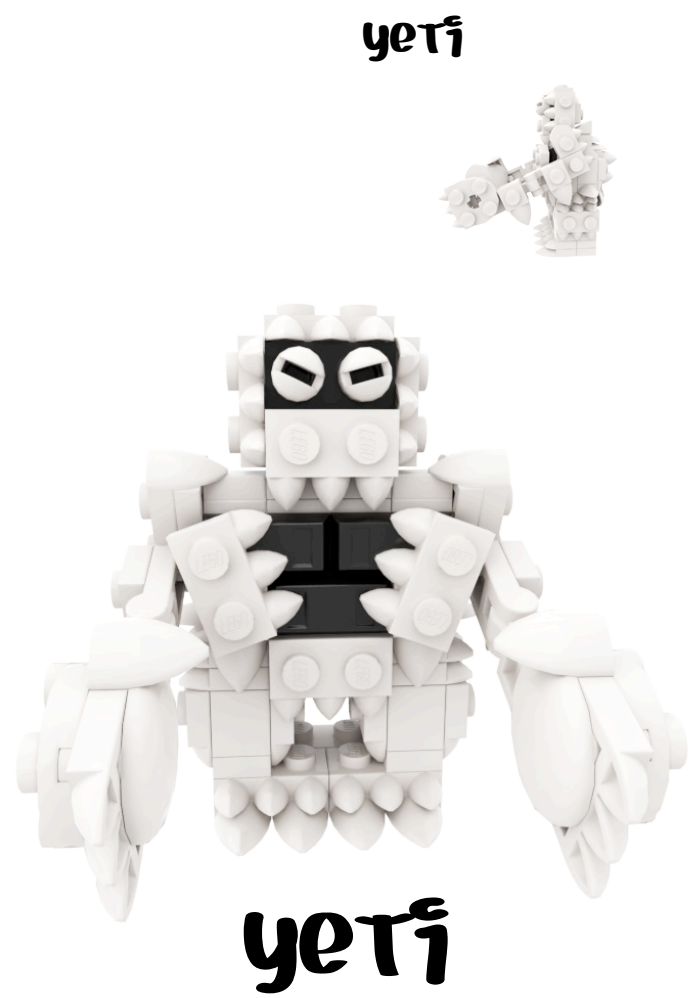



3x
99563, 11



2x
26604, 1



23x
15208, 1



2x
2654, 1



1x
44728, 1



1x
99207, 11



18x
49668, 1



2x
15209, 1



2x
4032b, 1

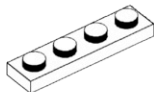

2x
3710, 1



2x
4592, 1



5x
3023, 1



1x
3004, 1

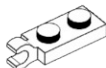

2x
63868, 1

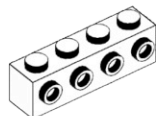

1x
30414, 1



4x
87087, 1



1x
85984, 1



1x
99781, 1

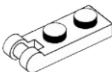

2x
60478, 1



4x
15070, 1



2x
28192, 1



2x
52107, 1



2x
99206, 1

KRAMPUS

1
2
3
4
5
6
7

Step 1: Attach two 1x2 red Technic bricks to a 1x4 red Technic brick. Step 2: Attach three 1x1 red Technic bricks to the top of the assembly. Step 3: Attach two 1x2 red Technic bricks to the top. Step 4: Attach a 2x1 red Technic brick to the side and a 1x1 red Technic brick to the top. Step 5: Attach a 2x1 red Technic brick to the side and a 1x1 red Technic brick to the top. Step 6: Attach a 1x1 red Technic brick to the top. Step 7: Attach a 1x1 red Technic brick to the top and a 1x1 red Technic brick to the side.

8
9
10
11
12
13
14

Step 8: Attach two 2x1 red Technic bricks to the top. Step 9: Attach one 1x2 red Technic brick to the top. Step 10: Attach two 2x1 red Technic bricks to the top. Step 11: Attach a grey Technic axle with a black gear to the top. Step 12: Attach a grey Technic axle with a black gear to the top. Step 13: Attach one 1x1 red Technic brick to the top, one 1x1 red Technic brick to the side, and one 1x1 red Technic brick to the top. Step 14: Attach one 1x1 red Technic brick to the top, one 1x1 red Technic brick to the side, and one 1x1 red Technic brick to the top.

15
16
17
18
19
20
21
22
23

Step 15: Attach two 2x2 red Technic bricks to the top. Step 16: Attach two 2x1 red Technic bricks to the top. Step 17: Attach a grey Technic axle with a black gear to the top. Step 18: Attach one 1x1 red Technic brick to the top, one 1x1 red Technic brick to the side, and one 2x1 red Technic brick to the top. Step 19: Attach three 1x1 red Technic bricks to the top and one 1x1 red Technic brick to the side. Step 20: Attach one 1x1 red Technic brick to the top, one 1x1 red Technic brick to the side, and one 2x1 red Technic brick to the top. Step 21: Attach two 2x1 red Technic bricks to the top. Step 22: Attach three 1x1 red Technic bricks to the top. Step 23: Attach one 1x1 red Technic brick to the top, one 1x1 red Technic brick to the side, and one 2x1 red Technic brick to the top.

24
25
26
27
28
29

Step 24: Attach a grey Technic axle with a black gear to the top. Step 25: Attach one 1x1 red Technic brick to the top and one 1x1 red Technic brick to the side. Step 26: Attach two 2x1 red Technic bricks to the top. Step 27: Attach two 2x1 red Technic bricks to the top. Step 28: Attach a grey Technic axle with a black gear to the top. Step 29: Attach a grey Technic axle with a black gear to the top.

31
32
33
34
35
36
37

Step 31: Attach one 1x1 red Technic brick to the top and one 1x1 red Technic brick to the side. Step 32: Attach one 1x1 red Technic brick to the top and one 1x1 red Technic brick to the side. Step 33: Attach two 2x1 red Technic bricks to the top. Step 34: Attach three 1x1 red Technic bricks to the top. Step 35: Attach two 2x1 red Technic bricks to the top. Step 36: Attach one 1x1 red Technic brick to the top and one 1x1 red Technic brick to the side. Step 37: Attach two 2x1 red Technic bricks to the top and one 1x1 red Technic brick to the side.

38
39
40
41

Step 38: Attach a red Technic piece to the top. Step 39: Attach one 1x2 red Technic brick to the top and one 1x1 red Technic brick to the side. Step 40: Attach one 1x1 red Technic brick to the top, one 1x1 red Technic brick to the side, and one 1x1 red Technic brick to the top. Step 41: Attach one 1x1 red Technic brick to the top, one 1x1 red Technic brick to the side, one 2x1 red Technic brick to the top, one 1x1 red Technic brick to the side, one 1x1 red Technic brick to the top, one 1x1 red Technic brick to the side, one 1x1 red Technic brick to the top, and one 1x1 red Technic brick to the side.

42
43

Step 42: Attach a red Technic piece to the top. Step 43: Attach a red Technic piece to the top.

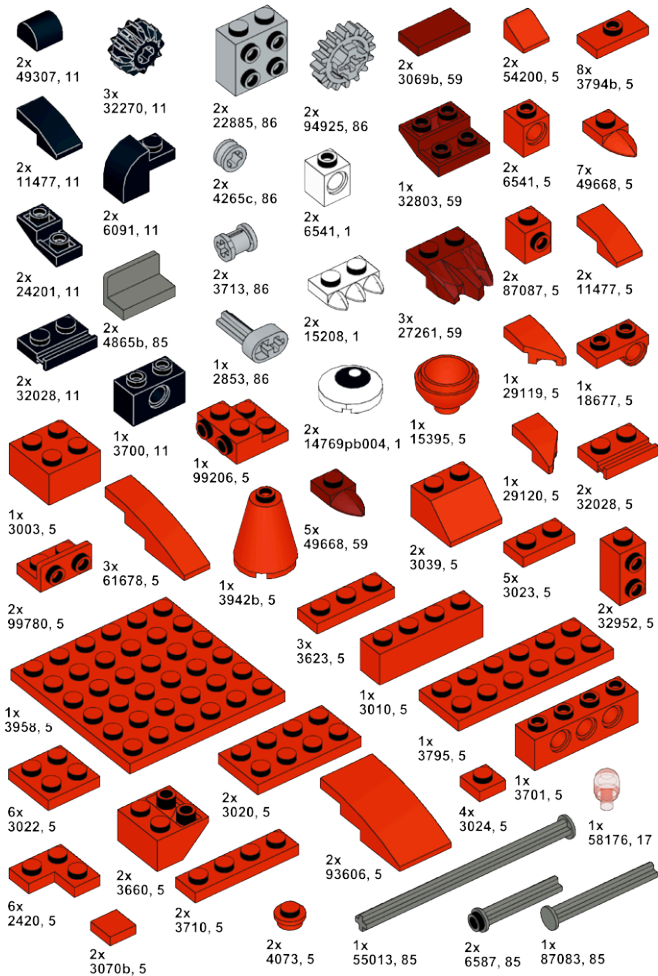

PHANTOMIAS



PHANTOMIAS

